

"Waimanalo Forest Reserve, Parts 1 and 1-A," Part 1 being all of Lot 5 as shown on Map 10 of Land Court Application 754 filed in the Office of the Assistant Registrar of the Land Court of the State of Hawaii, containing an area of 88.554 acres, covered by Transfer Certificate of Title No. 356,764 issued to the State of Hawaii, Lot 5 is SUBJECT, HOWEVER, to the following encumbrances:

1. Restriction of Vehicle Access Rights as shown on Map 10 as set forth by Land Court Order No. 16997, and

2. Easement 6 for Drainage Purposes as shown on Map 23 as set forth by Land Court Order No. 35828,

Lot 5 is SUBJECT, ALSO, to any other encumbrances that may be noted on Transfer Certificate of Title No 356,764.

Part 1-A, being all of Lot 169 as shown on Map 28 of Land Court Application 754 filed in the Office of the Assistant Registrar of the Land Court of the State of Hawaii, containing an area of 309.984 acres, covered by Transfer Certificate of Title No. 389,839 issued to the State of Hawaii, Lot 169 is SUBJECT, HOWEVER, to the following encumbrances:

1. Restriction of abutter's rights of vehicle access as shown on Map 6, as amended as set forth by Land Court Order No. 11375,

2. Easement 7 for Drainage Purposes as shown on Map 24 as set forth by Land Court Order No. 35829, and

3. Easement 8 for Slope Purposes as shown on Map 24 as set forth by Land Court Order No. 35829.

Lot 169 is SUBJECT, ALSO, to any other encumbrances that may be noted on Transfer Certificate of Title No. 389,839. Both Part 1 and Part 1-A are more particularly described in Exhibit "A which is attached hereto and made a part hereof, said exhibit being a survey description prepared by the Survey Division, Department of Accounting and General Services, State of Hawaii, being designated C.S.F. No. 25,431 and dated May 28, 2015; and

"Waimanalo Forest Reserve, Part 2," containing a gross area of 1536.00 acres, more or less and a net area of 1346.00 acres, more or less, SUBJECT, HOWEVER, to Hawaiian Electric Company, Ltd., Pole and Wire Line Easements, more particularly described in Exhibit "B" and delineated on Exhibit "C," both of



which are attached hereto and made parts hereof, said exhibits being respectively, a survey description and survey map prepared by the Survey Division, Department of Accounting and General Services, State of Hawaii, both being designated C.S.F. No. 25,432 and dated May 28, 2015.

SUBJECT, HOWEVER, to the condition that upon cancellation of this executive order or in the event of non-use or abandonment of the premises or any portion thereof for a continuous period of one (1) year, or for any reason whatsoever, the State of Hawaii, Department of Land and Natural Resources, Division of Forestry and Wildlife shall, within a reasonable time, restore the premises to a condition satisfactory and acceptable to the Department of Land and Natural Resources, State of Hawaii.

SUBJECT, FURTHER, to disapproval by the Legislature by two-thirds vote of either the Senate or the House of Representatives or by majority vote of both, in any regular or special session next following the date of this Executive Order.

This executive order does not authorize the recipient of the set aside to sell or exchange or otherwise relinquish the State of Hawaii's title to the subject public land.

IN WITNESS WHEREOF, I have hereunto set my hand and caused the Great Seal of the State of Hawaii to be affixed. Done at the Capitol at Honolulu this 21ST day of SEPTEMBER, 2015.



DAVID Y. IGE
Governor of the State of Hawaii

APPROVED AS TO FORM:



COLIN J. LAU
Deputy Attorney General

Dated: 8/28/15

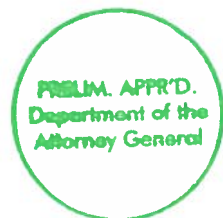

STATE OF HAWAII

Office of the Lieutenant Governor

THIS IS TO CERTIFY that the within is a true copy of Executive Order No. 4490 setting aside land for public purposes, the original of which is on file in this office.

IN TESTIMONY WHEREOF, the Lieutenant Governor of the State of Hawaii, has hereunto subscribed his name and caused the Great Seal of the State to be affixed.



SHAN S. TSUTSUI
Lieutenant Governor of the State of Hawaii

DONE in Honolulu, this 22nd day of September, A.D. 2015





STATE OF HAWAII
SURVEY DIVISION
DEPARTMENT OF ACCOUNTING AND GENERAL SERVICES
HONOLULU

C.S.F. No. 25,431

May 28, 2015

WAIMANALO FOREST RESERVE

PARTS 1 AND 1-A

Kailua, Koolaupoko, Oahu, Hawaii

PART 1:

Being all of Lot 5 as shown on Map 10 of Land Court Application 754 filed in the Office of the Assistant Registrar of the Land Court of the State of Hawaii containing an AREA OF 88.554 ACRES covered by Transfer Certificate of Title No. 356,764 issued to the State of Hawaii (Land Office Deed S-27824).

Lot 5 is SUBJECT, HOWEVER, to the following encumbrances:

1. Restriction of Vehicle Access Rights as shown on Map 10 as set forth by Land Court Order No. 16997.
2. Easement 6 for Drainage Purposes as shown on Map 23 as set forth by Land Court Order No. 35828.

Lot 5 is SUBJECT, ALSO, to any other encumbrances that may be noted on Transfer Certificate of Title No. 356,764.

PART 1-A:

Being all of Lot 169 as shown on Map 28 of Land Court Application 754 filed in the Office of the Assistant Registrar of the Land Court of the State of Hawaii containing an AREA OF 309.984 ACRES covered by Transfer Certificate of Title No. 389,839 issued to the State of Hawaii (Land Office Deed S-27824).



Lot 169 is SUBJECT, HOWEVER, to the following encumbrances:

1. Restriction of abutter's rights of vehicle access as shown on Map 6, as amended as set forth by Land Court Order No. 11375.
2. Easement 7 for Drainage Purposes as shown on Map 24 as set forth by Land Court Order No. 35829.
3. Easement 8 for Slope Purposes as shown on Map 24 as set forth by Land Court Order No. 35829.

Lot 169 is SUBJECT, ALSO, to any other encumbrances that may be noted on Transfer Certificate of Title No. 389,839.

SURVEY DIVISION
DEPARTMENT OF ACCOUNTING AND GENERAL SERVICES
STATE OF HAWAII

By: *Gerald Z. Yonashiro*
Gerald Z. Yonashiro
Land Surveyor

rk

Compiled from
Ld. Ct. Records.





STATE OF HAWAII
SURVEY DIVISION
DEPARTMENT OF ACCOUNTING AND GENERAL SERVICES
HONOLULU

C.S.F. No. 25,432

May 28, 2015

WAIMANALO FOREST RESERVE

PART 2

Kailua, Koolaupoko, Oahu, Hawaii

Comprising the following acquired by the State of Hawaii by FINAL ORDER OF CONDEMNATION, Civil No. 86-3057, dated August 24, 1990 and recorded as Document No. 90-142962 (Land Office Deed S-27824):

- A. All of Royal Patent 3062, Land Commission Award 5536, Apana 2 to Kaiewe.
- B. Portion of Grant 386 to Hana Kaoo.
- C. Portion of Grant 212 to Paul F. Manini.
- D. Portion of Grant 181 to William Jarrett.
- E. Portion of Royal Patent 7983, Land Commission Award 4452, Apana 12 to H. Kalama.
- F. Portion of Royal Patent 4475, Land Commission Award 7713, Part 2, Apana 45 to V. Kamamalu.

Being also a portion of Waimanalo Forest Reserve, Governor's Proclamation dated January 3, 1923.



Beginning on the top of the main Koolau Range at the northwest corner of this parcel of land and at the southwest corner of Lot 169 as shown on Map 28 of Land Court Application 754, the coordinates of said point of beginning referred to Government Survey Triangulation Station "KAILUA" being 10,831.84 feet South and 4671.31 feet West, thence running by azimuths measured clockwise from True South:-

- | | | |
|-----|--------------|---|
| 1. | 268° 29' 30" | 4548.41 feet along Lot 169 as shown on Map 28 of Land Court Application 754; |
| 2. | 347° 08' | 48.34 feet along the remainder of Grant 386 to Hana Kao; |
| 3. | 286° 12' | 1014.60 feet along the remainder of Grant 386 to Hana Kao; |
| 4. | 293° 29' | 769.30 feet along the remainder of Grant 386 to Hana Kao, Grant 212 to Paul F. Manini and Grant 181 to William Jarrett; |
| 5. | 263° 05' | 888.92 feet along the remainder of Grant 181 to William Jarrett; |
| 6. | 342° 17' 10" | 76.40 feet along Api Spring Reserve, Governor's Executive Order 784; |
| 7. | 221° 07' 40" | 42.10 feet along Api Spring Reserve, Governor's Executive Order 784; |
| 8. | 220° 30' | 200.79 feet along Agricultural Research Facility Site, Governor's Executive Order 3726; |
| 9. | 7° 00' | 380.00 feet along Agricultural Research Facility Site, Governor's Executive Order 3726; |
| 10. | 57° 30' | 1260.00 feet along Agricultural Research Facility Site, Governor's Executive Order 3726; |



11. 309° 00' 350.00 feet along Agricultural Research Facility Site, Governor's Executive Order 3726;
12. 4° 00' 180.00 feet along Agricultural Research Facility Site, Governor's Executive Order 3726;
13. 327° 30' 1160.00 feet along Agricultural Research Facility Site, Governor's Executive Order 3726;
14. 21° 30' 570.00 feet along Agricultural Research Facility Site, Governor's Executive Order 3726;
15. 310° 00' 710.00 feet along Agricultural Research Facility Site, Governor's Executive Order 3726;
16. 162° 00' 583.00 feet along Agricultural Research Facility Site, Governor's Executive Order 3726;
17. 210° 30' 970.00 feet along Agricultural Research Facility Site, Governor's Executive Order 3726;
18. 187° 45' 1250.00 feet along Agricultural Research Facility Site, Governor's Executive Order 3726;
19. 145° 00' 260.00 feet along Agricultural Research Facility Site, Governor's Executive Order 3726;
20. 240° 00' 560.00 feet along Agricultural Research Facility Site, Governor's Executive Order 3726;
21. 187° 00' 188.54 feet along Agricultural Research Facility Site, Governor's Executive Order 3726;
22. 324° 47' 698.03 feet along the remainders of Grant 181 to William Jarrett and R.P. 7983, L.C. Aw. 4452, Ap. 12 to H. Kalama;
23. 341° 33' 1941.20 feet along the remainders of R.P. 7983, L.C. Aw. 4452, Ap. 12 to H. Kalama and R.P. 4475, L.C. Aw. 7713, Part 2, Ap. 45 to V. Kamamalu;



- | | | |
|-----|----------|---|
| 24. | 266° 09' | 1631.50 feet along the remainder of R.P. 4475, L.C. Aw. 7713, Part 2, Ap. 45 to V. Kamamalu; |
| 25. | 314° 13' | 605.79 feet along the remainder of R.P. 4475, L.C. Aw. 7713, Part 2, Ap. 45 to V. Kamamalu; |
| 26. | 284° 55' | 182.26 feet along the remainder of R.P. 4475, L.C. Aw. 7713, Part 2, Ap. 45 to V. Kamamalu and along R.P. 2233, L.C. Aw. 6168 to Oneawa; |
| 27. | 281° 00' | 231.00 feet along R.P. 2233, L.C. Aw. 6168 to Oneawa; |
| 28. | 328° 00' | 158.40 feet along R.P. 2233, L.C. Aw. 6168 to Oneawa; |
| 29. | 217° 00' | 99.78 feet along R.P. 2233, L.C. Aw. 6168 to Oneawa; |
| 30. | 284° 55' | 650.00 feet along the remainder of R.P. 4475, L.C. Aw. 7713, Part 2, Ap. 45 to V. Kamamalu; |
| 31. | 264° 31' | 660.40 feet along the remainder of R.P. 4475, L.C. Aw. 7713, Part 2, Ap. 45 to V. Kamamalu to the top of ridge on the boundary between the lands of Kailua and Waimanalo; |

Thence along the top of ridge on the boundary between the lands of Kailua and Waimanalo for the next two (2) courses, the direct azimuths and distances between points on said top of ridge being:

- | | | |
|-----|-------------|---|
| 32. | 23° 25' 10" | 832.22 feet to Government Survey Triangulation Station "GAP"; |
| 33. | 36° 29' 53" | 4575.45 feet to Government Survey Triangulation Station "LANIPO" on the top of main Koolau Range; |



Thence along the top of the main Koolau Range for the next three (3) courses, the direct azimuths and distances between points on said top of main Koolau Range being:

- 34. 103° 32' 30" 6138.23 feet to a peak called Mt. Olympus;
- 35. 148° 29' 7495.02 feet to Government Survey
Triangulation Station
"KONAHUANUI";
- 36. 187° 06' 55" 305.69 feet to the point of beginning and
containing a GROSS AREA OF
1536.00 ACRES, MORE OR
LESS and a NET AREA OF
1346.00 ACRES, MORE OR
LESS after excluding therefrom
Revocable Permit No.7242
containing an area of 190.00
Acres as shown on plan attached
hereto and made a part hereof.

SUBJECT, HOWEVER, to Hawaiian Electric Company, Ltd. Pole and Wire Line Easements over, under and across the above-described Part 2 as shown on map filed under C.S.F. No. 25,432 dated May 28, 2015 attached hereto and made a part hereof.

SURVEY DIVISION
DEPARTMENT OF ACCOUNTING AND GENERAL SERVICES
STATE OF HAWAII

By: *Gerald Z. Yonashiro*
Gerald Z. Yonashiro
Land Surveyor rk

Compiled from CSF 22,416
and other Govt. Survey Records.

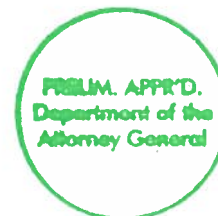

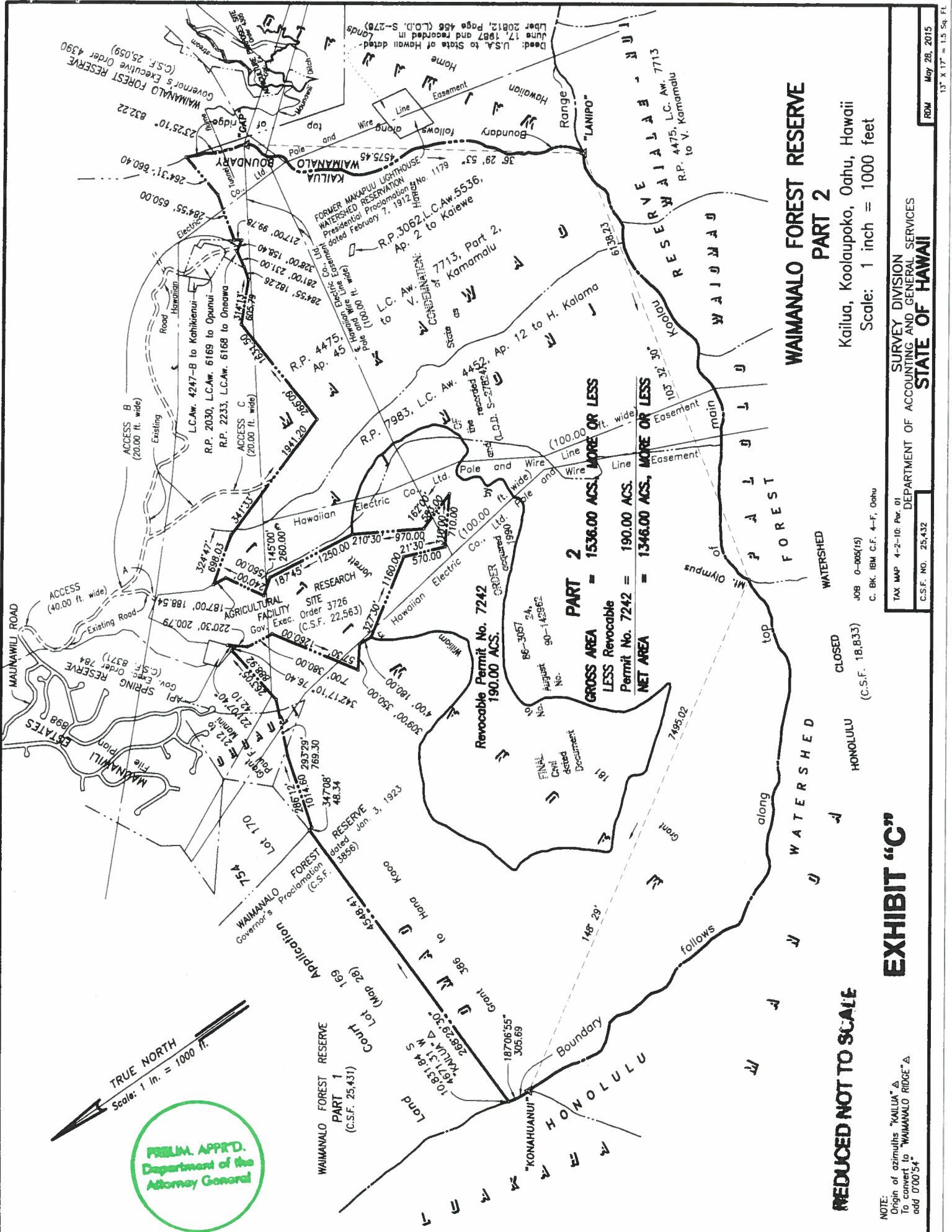

TRUE NORTH
Scale: 1 in. = 1000 ft.

PRELIM. APPRD.
Department of the
Attorney General

REDUCED NOT TO SCALE

NOTE:
Origin of azimuths "KAILUA" Δ
To convert to "WAIMANALO RIDGE" Δ
add 0°00'54"

EXHIBIT "C"

CLOSED
(C.S.F. 18,833)

JOB 0-006(15)
C. BK. IBM C.F. 4-F, Oahu

TAX MAP 4-2-10: Par. 01
DEPARTMENT OF ACCOUNTING AND GENERAL SERVICES
C.S.F. NO. 25,432

WAIMANALO FOREST RESERVE
PART 2

Kailua, Koolauloko, Oahu, Hawaii
Scale: 1 inch = 1000 feet

PART 2 = 1536.00 ACS. MORE OR LESS
GROSS AREA
LESS Revocable Permit No. 7242 = 190.00 ACS.
NET AREA = 1346.00 ACS. MORE OR LESS

SURVEY DIVISION
DEPARTMENT OF ACCOUNTING AND GENERAL SERVICES
STATE OF HAWAII