



NOW, THEREFORE, I, DAVID Y. IGE, Governor of the State of Hawaii, by virtue of the authority vested in me under Section 171-11, Hawaii Revised Statutes, as amended, do hereby order that the following described land, identified as "Withdrawal Portion of Sand Island Recreational Area, Governor's Executive Order 2704," situate at Mokauea, Sand Island, Honolulu, Oahu, Hawaii, containing an area of 6.618 acres, more or less, more particularly described in Exhibit "A" and delineated on Exhibit "B," both of which are attached hereto and made parts hereof, said exhibits being respectively, a survey description and survey map prepared by the Survey Division, Department of Accounting and General Services, State of Hawaii, being designated as C.S.F. No. 25,461 and dated October 29, 2015, is hereby withdrawn from the Operation of Governor's Executive Order No. 2704 dated October 17, 1974.

SUBJECT to disapproval by the Legislature by two-thirds vote of either the Senate or the House of Representatives or by majority vote of both, in any regular or special session next following the date of this Executive Order.

IN WITNESS WHEREOF, I have hereunto set my hand and caused the Great Seal of the State of Hawaii to be affixed. Done at the Capitol at Honolulu this 19TH day of DECEMBER, 2015.

bc DAVID Y. IGE
Governor of the State of Hawaii

APPROVED AS TO FORM:

AMANDA J. WESTON
Deputy Attorney General

Dated: 11/20/15



STATE OF HAWAII

Office of the Lieutenant Governor

THIS IS TO CERTIFY That the within is a true copy of Executive Order No. **4498** withdrawing land from the operation of Executive Order No. 2704, the original of which is on file in this office.

IN TESTIMONY WHEREOF, the Lieutenant Governor of the State of Hawaii, has hereunto subscribed his name and caused the Great Seal of the State to be affixed.



SHAN S. TSUTSUI
Lieutenant Governor of the State of Hawaii

DONE in Honolulu, this 21st day of
December, A.D. 2015

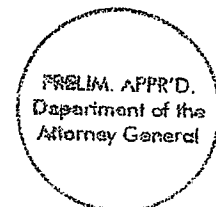



STATE OF HAWAI'I
SURVEY DIVISION
DEPARTMENT OF ACCOUNTING AND GENERAL SERVICES
HONOLULU

C.S.F. No. 25,461

October 29, 2015

WITHDRAWAL
PORTION OF SAND ISLAND RECREATIONAL AREA
Governor's Executive Order 2704

Mokauea, Sand Island, Honolulu, Oahu, Hawaii

Being a portion of the Former Mokauea Fishery covered by the following:

- A. Judgment dated July 11, 1961, Law No. 16696 in favor of the State of Hawaii and covered by Quitclaim Deed, Parcel 2: Hawaiian Dredging Company, Limited to the Territory of Hawaii dated August 6, 1952 and recorded in Liber 2613, Pages 27-40 (Land Office Deed 10605).
- B. Tract "G" of Quitclaim Deed: United States of America to the State of Hawaii dated July 23, 1965 and recorded in Liber 5334, Page 226 (Land Office Deed S-24133).

Beginning at the southeast corner of this parcel of land and on the southwest side of Sand Island Parkway, the coordinates of said point of beginning referred to Government Survey Triangulation Station "U.S.E. NORHT BASE" being 3315.33 feet North and 5379.47 feet West, thence running by azimuths measured clockwise from True South:-

1. 64° 00' 307.18 feet along the remainder of the Former Mokauea Fishery;

PRELIM. APPR'D.
Department of the
Attorney General

2. Thence along the remainder of the Former Mokauea Fishery on a curve to the left with a radius of 100.00 feet, the chord azimuth and distance being:
19° 00' 141.42 feet

3. 334° 00' 101.86 feet along the remainder of the Former Mokauea Fishery;

4. 64° 00' 20" 333.81 feet along the remainder of Sand Island State Recreational Area, Governor's Executive Order 2704;

Thence along highwater mark at seashore for the next three (3) courses, the direct azimuths and distances between points along said highwater mark at seashore being:

5. 155° 15' 246.44 feet;

6. 180° 38' 50" 260.50 feet;

7. 236° 49' 623.71 feet;

5. 334° 00' 20" 355.38 feet along the southwest side of Sand Island Parkway to the point of beginning and containing an AREA OF 6.618 ACRES, MORE OR LESS.

SURVEY DIVISION
DEPARTMENT OF ACCOUNTING AND GENERAL SERVICES
STATE OF HAWAII

By: Gerald Z. Yonashiro
Gerald Z. Yonashiro
Land Surveyor rk

Compiled from CSF 17,079 and other Govt. Survey Records.



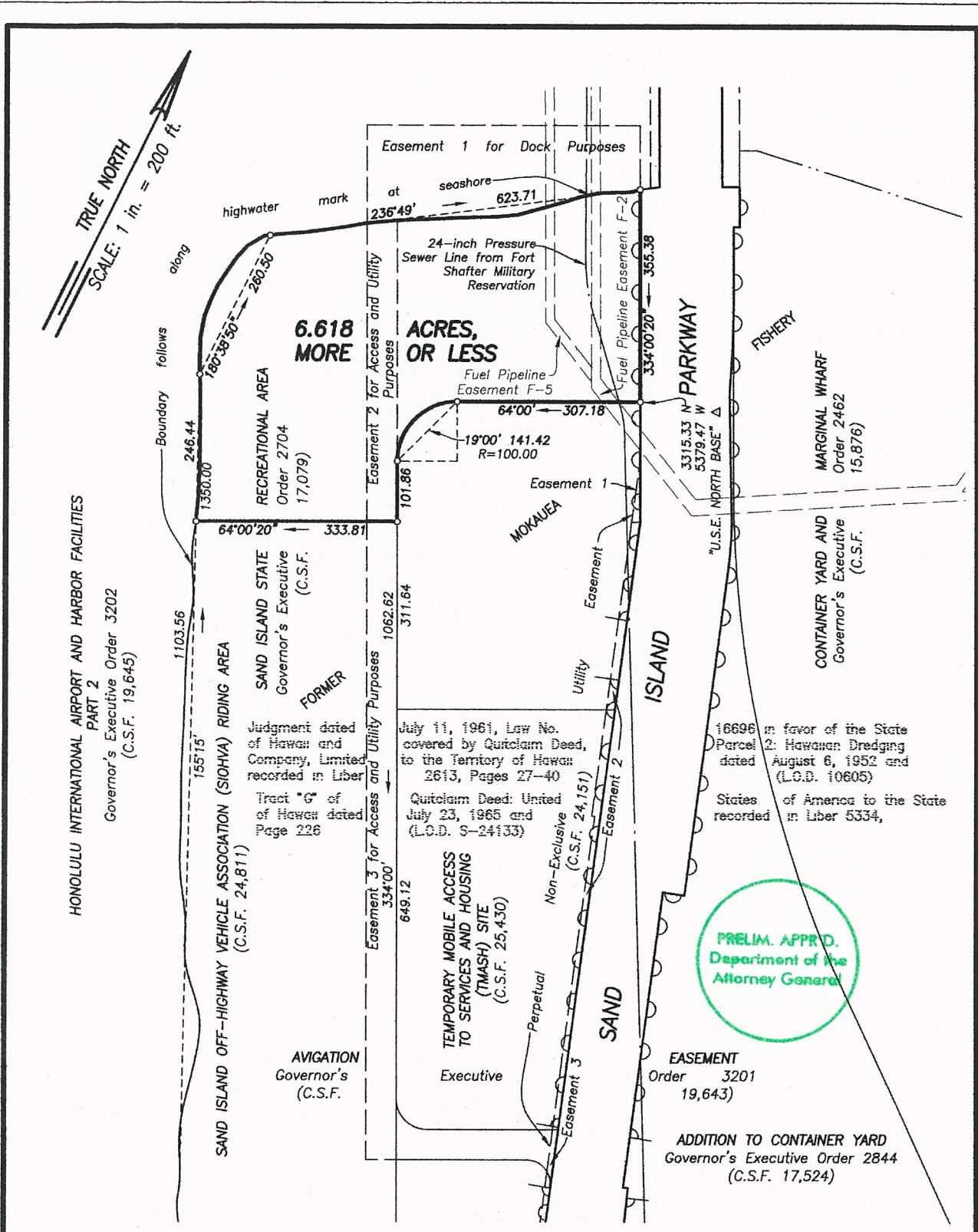

REDUCED NOT TO SCALE

WITHDRAWAL

EXHIBIT "B"

PORTION OF SAND ISLAND STATE RECREATIONAL AREA

Governor's Executive Order 2704

Mokauea, Sand Island, Honolulu, Oahu, Hawaii

Job O-216(15)

C. BK.

Scale: 1 inch = 200 feet



Denotes no vehicle access permitted
Denotes access permitted

TMK 1-5-41: Por. 06

SURVEY DIVISION
DEPARTMENT OF ACCOUNTING AND GENERAL SERVICES

C.S.F. NO. 25,461

STATE OF HAWAII

HBD October 29, 2015