

	)	
	)	
	)	
	)	
	)	
	)	
	)	
	)	
	)	
	)	
	)	
LAND COURT SYSTEM	)	REGULAR SYSTEM
Return by Mail ( )	Pickup ( )	To:

Total Number of Pages:

---

Tax Map Key Nos. (1) 1-5-041:Portions of 006, 130 and 334

FROM: STATE OF HAWAII  
BOARD OF LAND AND NATURAL RESOURCES

TO: STATE OF HAWAII  
DEPARTMENT OF LAND AND NATURAL RESOURCES  
Division of Boating and Ocean Recreation  
333 Queen Street, Room 300  
Honolulu, Hawaii 96813

EXECUTIVE ORDER NO. **4494**

SETTING ASIDE LAND FOR PUBLIC PURPOSES

BY THIS EXECUTIVE ORDER, I, the undersigned, Governor of the State of Hawaii, by virtue of the authority in me vested by Section 171-11, Hawaii Revised Statutes, as amended, and every other authority me hereunto enabling, do hereby order that the public land and improvements hereinafter described be, and the same is, hereby set aside for the following public purposes:

FOR BOAT LAUNCHING FACILITIES, to be under the control and management of the State of Hawaii, Department of Land and Natural Resources, Division of Boating and Ocean Recreation, being that parcel of land situate at Mokauea, Sand Island, Honolulu, Oahu, Hawaii, and identified as "Boat Launching



Facility Site," containing an area of 3.543 acres, more or less, TOGETHER WITH, Easement 3 for Access and Utility Purposes, and SUBJECT, HOWEVER, to Easement 2 for Access and Utility Purposes and Avigation Easement and other rules and regulations as set forth by Hawaii Aeronautics Commission, more particularly described in Exhibit "A" and delineated on Exhibit "B," both of which are attached hereto and made parts hereof, said exhibits being respectively, a survey description and survey map prepared by the Survey Division, Department of Accounting and General Services, State of Hawaii, both being designated C.S.F. No. 25,464 and dated October 29, 2015.

SUBJECT, HOWEVER, to the condition that upon cancellation of this executive order or in the event of non-use or abandonment of the premises or any portion thereof for a continuous period of one (1) year, or for any reason whatsoever, the State of Hawaii, Department of Land and Natural Resources, Division of Boating and Ocean Recreation shall, within a reasonable time, restore the premises to a condition satisfactory and acceptable to the Department of Land and Natural Resources, State of Hawaii.

SUBJECT, FURTHER, to disapproval by the Legislature by two-thirds vote of either the Senate or the House of Representatives or by majority vote of both, in any regular or special session next following the date of this Executive Order.

This executive order does not authorize the recipient of the set aside to sell or exchange or otherwise relinquish the State of Hawaii's title to the subject public land.

IN WITNESS WHEREOF, I have hereunto set my hand and caused the Great Seal of the State of Hawaii to be affixed. Done at the Capitol at Honolulu this 19<sup>TH</sup> day of DECEMBER, 2015.

  
\_\_\_\_\_  
DAVID Y. IGE  
Governor of the State of Hawaii

APPROVED AS TO FORM:

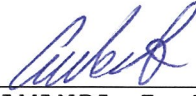
  
\_\_\_\_\_  
AMANDA J. WESTON  
Deputy Attorney General

Dated: 11/20/15



STATE OF HAWAII

Office of the Lieutenant Governor

THIS IS TO CERTIFY That the within is a true copy of Executive Order No. ~~4494~~ **4494** setting aside land for public purposes, the original of which is on file in this office.

IN TESTIMONY WHEREOF, the Lieutenant Governor of the State of Hawaii, has hereunto subscribed his name and caused the Great Seal of the State to be affixed.

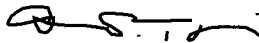

---

SHAN S. TSUTSUI  
Lieutenant Governor of the State of Hawaii

DONE in Honolulu, this 21<sup>st</sup> day of December, A.D. 2015

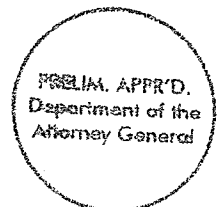



STATE OF HAWAII  
SURVEY DIVISION  
DEPARTMENT OF ACCOUNTING AND GENERAL SERVICES  
HONOLULU

C.S.F. No. 25,464

October 29, 2015

BOAT LAUNCHING FACILITY SITE

Mokauea, Sand Island, Honolulu, Oahu, Hawaii

Being a portion of the Former Mokauea Fishery covered by the following:

- A. Judgment dated July 11, 1961, Law No. 16696 in favor of the State of Hawaii and covered by Quitclaim Deed, Parcel 2: Hawaiian Dredging Company, Limited to the Territory of Hawaii dated August 6, 1952 and recorded in Liber 2613, Pages 27-40 (Land Office Deed 10605).
- B. Tract "G" of Quitclaim Deed: United States of America to the State of Hawaii dated July 23, 1965 and recorded in Liber 5334, Page 226 (Land Office Deed S-24133).

Beginning at the southeast corner of this parcel of land, the true azimuth and distance to the southwest corner of Parcel B of Educational Purposes Site being:  $334^{\circ} 00'$  311.64 feet, the coordinates of said point of beginning referred to Government Survey Triangulation Station "U.S.E. NORTH BASE" being 2955.40 feet North and 5656.97 feet West, thence running by azimuths measured clockwise from True South:-

- 1.  $64^{\circ} 00' 20''$  333.81 feet along Sand Island Recreational Area, Governor's Executive Order 2704 to highwater mark at seashore;

PRELIM. APPR'D.  
Department of the  
Attorney General



Thence along highwater mark at seashore for the next three (3) courses, the direct azimuths and distances between points along said highwater mark at seashore being:

- 2. 155° 15'                                    246.44 feet;
- 3. 180° 38' 50"                            260.50 feet;
- 4. 237° 08' 16"                            213.13 feet;
- 5. 334° 00'                                    504.71 feet along Parcels A and B of Educational Purposes Site to the point of beginning and containing an AREA OF 3.543 ACRES, MORE OR LESS.

TOGETHER WITH, EASEMENT 3 for Access and Utility Purposes as shown on plan attached hereto and made a part hereof and more particularly described as follows:

Being a portion of the Former Mokauea Fishery covered by the following:

- A. Judgment dated July 11, 1961, Law No. 16696 in favor of the State of Hawaii and covered by Quitclaim Deed, Parcel 2: Hawaiian Dredging Company, Limited to the Territory of Hawaii dated August 6, 1952 and recorded in Liber 2613, Pages 27-40 (Land Office Deed 10605).
- B. Tract "G" of Quitclaim Deed: United States of America to the State of Hawaii dated July 23, 1965 and recorded in Liber 5334, Page 226 (Land Office Deed S-24133).

Beginning at the southeast corner of this easement, at the northeast corner of Parcel 2 of Maritime Purposes Site, Governor's Executive Order 4170 and on the west side of Sand Island Parkway, the coordinates of said point of beginning referred to Government Survey Triangulation Station "U.S.E. NORTH BASE" being 2074.15 feet North and 4940.53 feet West, thence running by azimuths measured clockwise from True South:-



1. Along Parcel 2 of Maritime Purposes Site, Governor's Executive Order 4170 on a curve to the left with a radius of 40.00 feet, the chord azimuth and distance being: 112° 51' 10" 60.24 feet;
2. 64° 00' 20" 267.98 feet along Parcel 2 of Maritime Purposes Site, Governor's Executive Order 4170 and the remainder of Sand Island State Recreational Area, Governor's Executive Order 2704;
3. 154° 00' 1060.75 feet along the remainder of Sand Island State Recreational Area, Governor's Executive Order 2704;
4. 244° 00' 20" 50.00 feet along Boat Launching Facility Site;
5. 334° 00' 960.76 feet along Parcel B of Educational Purposes Site and Temporary Mobile Access to Services and Housing (TMASH) Site;
6. Thence along Temporary Mobile Access to Services and Housing (TMASH) Site on a curve to the left with a radius of 50.00 feet, the chord azimuth and distance being: 289° 00' 10" 70.71 feet;
7. 244° 00' 20" 220.51 feet along Temporary Mobile Access to Services and Housing (TMASH) Site;
8. 341° 42' 96.22 feet along the west side of Sand Island Parkway to the point of beginning and containing an AREA OF 67,395 SQUARE FEET.



SUBJECT, HOWEVER, to the following easements as shown on plan attached hereto and made a part hereof.

1. Easement 2 for Access and Utility Purposes.
2. Avigation Easement and other rules and regulations as set forth by Hawaii Aeronautics Commission.

SURVEY DIVISION  
DEPARTMENT OF ACCOUNTING AND GENERAL SERVICES  
STATE OF HAWAII

By: *Gerald Z. Yonashiro*  
Gerald Z. Yonashiro  
Land Surveyor rk

Compiled from map and desc.  
furn. by Control Point Surveying,  
Inc. Said map and desc. have been  
examined and checked as to form  
and mathematical correctness but not  
on the ground by the Survey Division.





TRUE NORTH  
SCALE: 1 in. = 200 ft.

HONOLULU INTERNATIONAL AIRPORT AND HARBOR FACILITIES  
PART 2  
Governor's Executive Order 3202  
(C.S.F. 19,645)

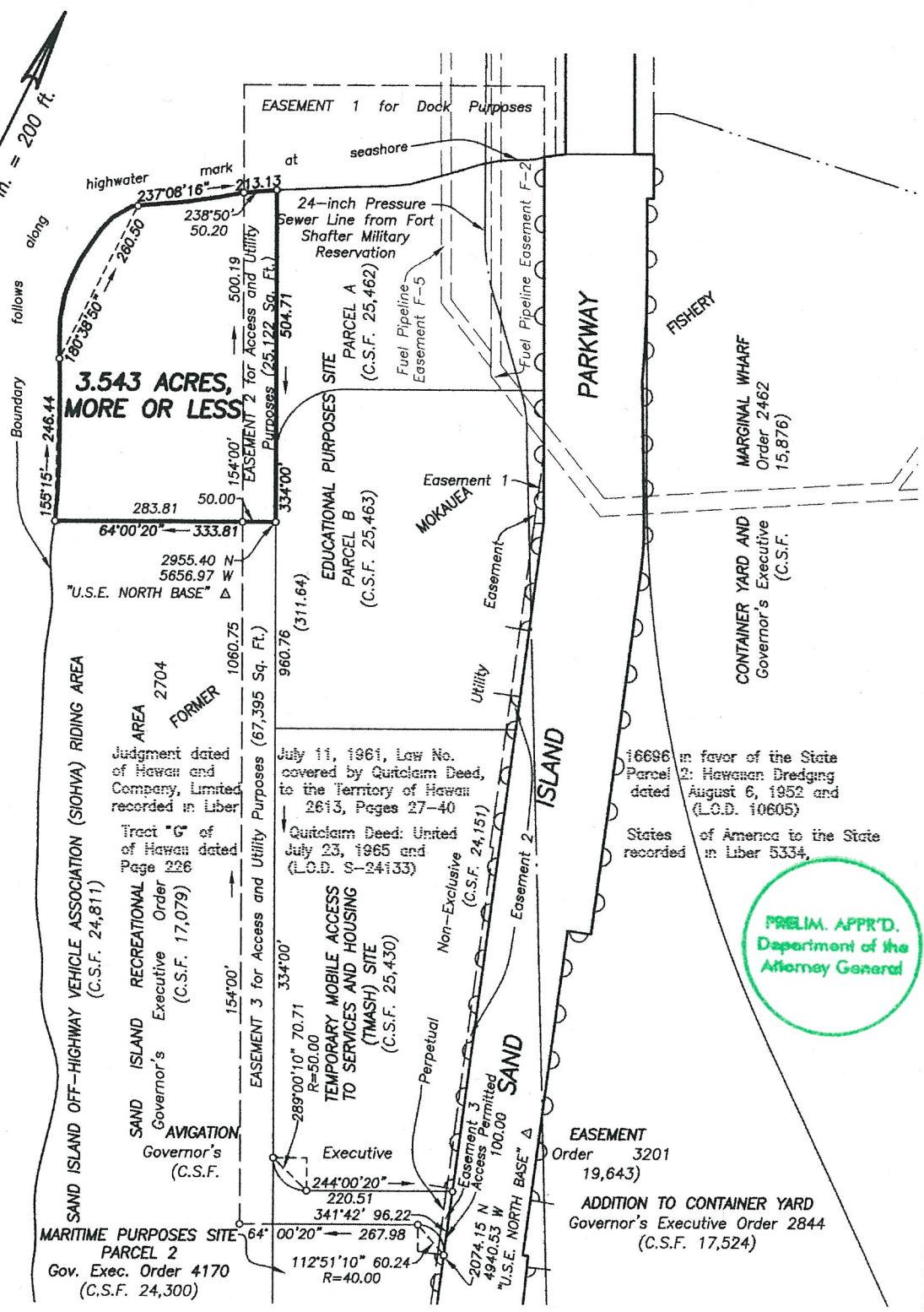

REDUCED NOT TO SCALE

EXHIBIT "B"

BOAT LAUNCHING FACILITY SITE

Mokauea, Sand Island, Honolulu, Oahu, Hawaii

Job O-216(15)

C. BK.

Scale: 1 inch = 200 feet

Denotes no vehicle access permitted  
Denotes access permitted

TMK 1-5-41: Pors. 06, 130 and 334

SURVEY DIVISION  
DEPARTMENT OF ACCOUNTING AND GENERAL SERVICES

STATE OF HAWAII

C.S.F. NO. 25,464

HBD October 29, 2015