

)  
)  
)  
)  
)  
)  
)  
)  
)  
)  
)  
)  
)  
)  
)  
)  
)  
)  
)  
LAND COURT SYSTEM ) REGULAR SYSTEM  
-----  
Return by Mail ( ) Pickup ( ) To:

Total Number of Pages:  
Tax Map Key No. (1) 1-2-025

FROM: STATE OF HAWAII  
BOARD OF LAND AND NATURAL RESOURCES

TO: STATE OF HAWAII  
DEPARTMENT OF TRANSPORTATION  
Harbors Division  
Hale Awa Ku Moku Building  
79 South Nimitz Highway  
Honolulu, Hawaii 96813-4898

EXECUTIVE ORDER NO. 4503

SETTING ASIDE LAND FOR PUBLIC PURPOSES

BY THIS EXECUTIVE ORDER, I, the undersigned, Governor of the State of Hawaii, by virtue of the authority in me vested by Section 171-11, Hawaii Revised Statutes, as amended, and every other authority me hereunto enabling, do hereby order that the public land hereinafter described be, and the same is, hereby set aside for the following public purposes:

FOR HARBOR PURPOSES SITE, to be under the control and management of the State of Hawaii, Department of Transportation, being that parcel of land situate at Mokauea, Kalihi, Honolulu, Oahu, Hawaii, identified as "Harbor Purposes Site," containing an



area of 21.284 acres, more or less, SUBJECT, HOWEVER, to Non-Exclusive Easement C for Communication Cable Purposes, and portion of Non-Exclusive Easement K-11 (15 ft. wide) for Transmission of Sources of Energy in favor of the State of Hawaii, more particularly described in Exhibit "A" and delineated on Exhibit "B," both of which are attached hereto and made parts hereof, said exhibits being respectively, a survey description and survey map prepared by the Survey Division, Department of Accounting and General Services, State of Hawaii, both being designated C.S.F. No. 25,495 and dated March 18, 2016.

SUBJECT, HOWEVER, to the condition that upon cancellation of this executive order or in the event of non-use or abandonment of the premises or any portion thereof for a continuous period of one (1) year, or for any reason whatsoever, the State of Hawaii, Department of Transportation shall, within a reasonable time, restore the premises to a condition satisfactory and acceptable to the Department of Land and Natural Resources, State of Hawaii.

SUBJECT, FURTHER, to disapproval by the Legislature by two-thirds vote of either the Senate or the House of Representatives or by majority vote of both, in any regular or special session next following the date of this Executive Order.

SUBJECT, FURTHER, to the reservations described in Quitclaim Deed dated April 20, 1993, recorded in the State of Hawaii, Bureau of Conveyances as Document No. 93-065665, including but not limited to the following:

1. The right of flight for the passage of aircraft in the airspace above the approach surface, together with the right to cause in said airspace such noise and such incidence of flight as may be inherent in the operation of aircraft landing at or operating on Honolulu International Airport.

2. The continuing and perpetual right to cut to ground level and remove trees, bushes, shrubs, or any other perennial growth or undergrowth extending into, or which in the future could infringe upon or extend into or above the approach surface.

3. The right to remove, raze or destroy those portions of buildings, other structures and land infringing upon or extending into the approach surface, together with the right to prohibit the future erection of buildings or other structures which would infringe upon or extend into said surface.



4. The right to mark and light as obstructions to air navigation, any and all structures, trees or other objects that may at any time project or extend above said surface.

5. The right of ingress to and egress from, and passage over the land within the approach area for the above purposes.

This executive order does not authorize the recipient of the set aside to sell or exchange or otherwise relinquish the State of Hawaii's title to the subject public land.

IN WITNESS WHEREOF, I have hereunto set my hand and caused the Great Seal of the State of Hawaii to be affixed. Done at the Capitol at Honolulu this 3<sup>rd</sup> day of JUNE, 2016.

  
\_\_\_\_\_  
DAVID Y. IGE  
Governor of the State of Hawaii

APPROVED AS TO FORM:

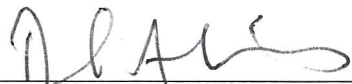
  
\_\_\_\_\_  
DANIEL A. MORRIS  
Deputy Attorney General

Dated: APR 21 2016



STATE OF HAWAII

Office of the Lieutenant Governor

THIS IS TO CERTIFY That the within is a true copy of Executive Order No. 4503 setting aside land for public purposes, the original of which is on file in this office.

IN TESTIMONY WHEREOF, the Lieutenant Governor of the State of Hawaii, has hereunto subscribed his name and caused the Great Seal of the State to be affixed.



SHAN S. TSUTSUI  
Lieutenant Governor of the State of Hawaii

DONE in Honolulu, this 15th day of June, A.D. 2016





STATE OF HAWAII  
SURVEY DIVISION  
DEPARTMENT OF ACCOUNTING AND GENERAL SERVICES  
HONOLULU

C.S.F. No. 25,495

March 18, 2016

HARBOR PURPOSES SITE

Mokauea, Kalihi, Honolulu, Oahu, Hawaii

Being a portion of Land Patent 8147 on a portion of Land Commission Award 6450, Apana 1 to Kaunuohua for W.L. Moehonua (Former Ananoho Fish Pond), being also portion of the Former Kapalama Military Reservation (Tract 1 of U.S. Civil No. 469) comprised of the following:

- A. Deed: United States of America to the State of Hawaii dated April 20, 1993 and recorded as Document No. 93-065665 (Land Office Deed S-27979).
- B. Portion of Deed: United States of America to the State of Hawaii dated October 29, 1990 and recorded as Document Nos. 90-167346 and 91-178693 (Land Office Deed S-27913).

Beginning at the northeast corner of this parcel of land, at the northwest corner of Piers 41 and 42 of Honolulu Harbor Complex, Governor's Executive Order 3013 and on the south boundary of Part 1 of Harbor and Light Industrial Complex, Governor's Executive Order 3947, the coordinates of said point of beginning referred to Government Survey Triangulation Station "PUNCHBOWL" being 2493.79 feet North and 12,179.10 feet West, thence running by azimuths measured clockwise from True South:-

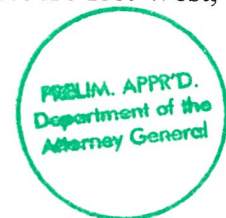

1. 5° 29' 686.84 feet along Piers 41 and 42 of Honolulu Harbor Complex, Governor's Executive Order 3013;
2. 95° 33' 534.06 feet along Honolulu Harbor, Governor's Executive Order 4206;
3. 6° 47' 241.28 feet along Honolulu Harbor, Governor's Executive Order 4206;
4. 93° 16' 56.04 feet along Honolulu Harbor, Governor's Executive Order 4206;
5. 104° 50' 202.77 feet along Honolulu Harbor, Governor's Executive Order 4206;
6. 119° 32' 166.27 feet along Honolulu Harbor, Governor's Executive Order 4206;
7. 140° 04' 30" 116.30 feet along Maritime Purposes Site;
8. 160° 27' 30" 93.53 feet along Maritime Purposes Site and Airport Purposes Site, Governor's Executive Order 4454;
9. 165° 53' 154.93 feet along Airport Purposes Site, Governor's Executive Order 4454;
10. 170° 46' 285.65 feet along Airport Purposes Site, Governor's Executive Order 4454;
11. 173° 22' 138.49 feet along Airport Purposes Site, Governor's Executive Order 4454;
12. 283° 23' 237.38 feet along Part 1 of Harbor and Light Industrial Complex, Governor's Executive Order 3947;
13. 193° 23' 272.00 feet along Part 1 of Harbor and Light Industrial Complex, Governor's Executive Order 3947;



14. 283° 23' 960.03 feet along Part 1 of Harbor and Light Industrial Complex, Governor's Executive Order 3947 to the point of beginning and containing an AREA OF 21.284 ACRES, MORE OR LESS.

SUBJECT, HOWEVER, to the following easements covered by Deed: United States of America to the State of Hawaii dated April 20, 1993 and recorded as Document No. 93-065665 (Land Office Deed S-27979) as shown on plan attached hereto and made a part hereof:

- A. Non-Exclusive Easement C for Communication Cable Purposes.
- B. Portion of Non-Exclusive Easement K-11 (15 ft. wide) for Transmission of Sources of Energy in favor of the State of Hawaii.

SURVEY DIVISION  
DEPARTMENT OF ACCOUNTING AND GENERAL SERVICES  
STATE OF HAWAII

By: Gerald Z. Yonashiro  
Gerald Z. Yonashiro  
Land Surveyor rk

Compiled from Doc. No. 93-065665,  
map and desc. furn. by R.M. Towill,  
ControlPoint Surveying, ESH and  
other Govt. Survey Records.



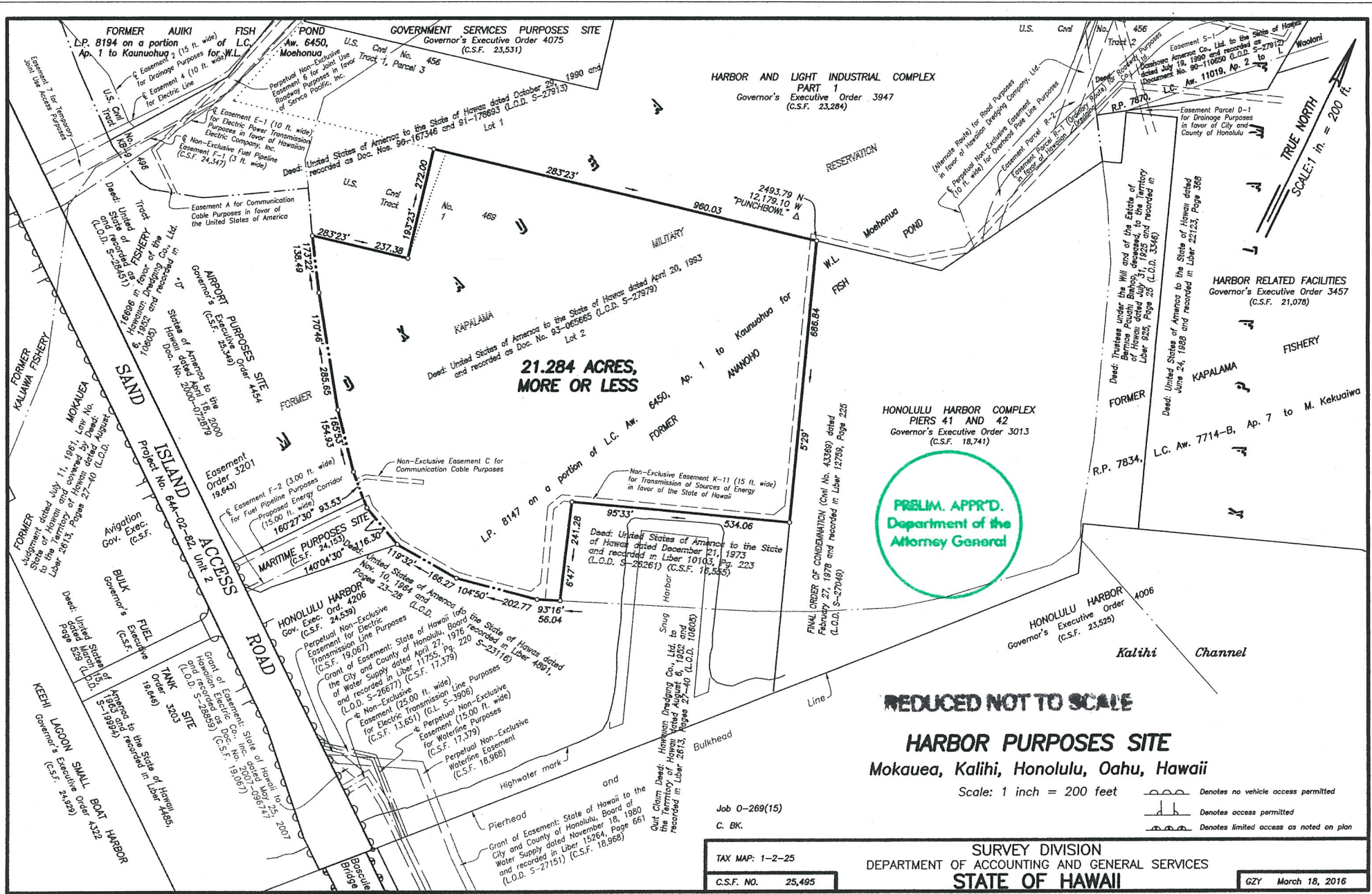

PRELIM. APPR'D.  
Department of the  
Attorney General

**REDUCED NOT TO SCALE**  
**HARBOR PURPOSES SITE**  
Mokauea, Kalihi, Honolulu, Oahu, Hawaii  
Scale: 1 inch = 200 feet

- Denotes no vehicle access permitted
- Denotes access permitted
- Denotes limited access as noted on plan

Job 0-269(15)  
C. BK.  
TAX MAP: 1-2-25  
C.S.F. NO. 25,495  
SURVEY DIVISION  
DEPARTMENT OF ACCOUNTING AND GENERAL SERVICES  
STATE OF HAWAII  
GZY March 18, 2016