

Pohukaina School Lot," containing an area of 94,423 square feet, SUBJECT, HOWEVER, to Perpetual Non-Exclusive Transformer Easement, future road rounding at the intersection of Keawe and Pohukaina Streets, and future road rounding at the intersection of Coral and Pohukaina Streets, more particularly described in Exhibit "A" and delineated on Exhibit "B," both of which are attached hereto and made parts hereof, said exhibits being respectively, a survey description and survey map prepared by the Survey Division, Department of Accounting and General Services, State of Hawaii, both being designated C.S.F. No. 25,233 and dated October 16, 2012.

SUBJECT, HOWEVER, to any existing encumbrances and reservations, and to the condition that upon cancellation of this executive order or in the event of non-use or abandonment of the premises or any portion thereof for a continuous period of one (1) year, or for any reason whatsoever, the Hawaii Housing Finance and Development Corporation, a public body and a body corporate and politic shall, within a reasonable time, restore the premises to a condition satisfactory and acceptable to the Department of Land and Natural Resources, State of Hawaii.

SUBJECT, FURTHER, to disapproval by the Legislature by two-thirds vote of either the Senate or the House of Representatives or by majority vote of both, in any regular or special session next following the date of this Executive Order.

This executive order does not authorize the recipient of the set aside to sell or exchange or otherwise relinquish the State of Hawaii's title to the subject public land.

IN WITNESS WHEREOF, I have hereunto set my hand and caused the Great Seal of the State of Hawaii to be affixed. Done at the Capitol at Honolulu this 19th day of May, 2017.

APPROVED AS TO FORM:

Colin Lau
COLIN E. LAU
Deputy Attorney General

Dated: 4/26/17

David Y. Ige
DAVID Y. IGE
Governor of the State of Hawaii



STATE OF HAWAII

Office of the Lieutenant Governor

THIS IS TO CERTIFY That the within is a true copy of Executive Order No. **4533** setting aside land for public purposes, the original of which is on file in this office.

IN TESTIMONY WHEREOF, the Lieutenant Governor of the State of Hawaii, has hereunto subscribed his name and caused the Great Seal of the State to be affixed.

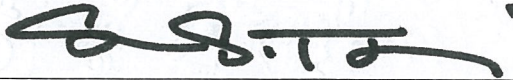

SHAN S. TSUTSUI
Lieutenant Governor of the State of Hawaii

DONE in Honolulu, this 26 day of
MAY, A.D. 2017





STATE OF HAWAII
SURVEY DIVISION
DEPARTMENT OF ACCOUNTING AND GENERAL SERVICES
HONOLULU

C.S.F. No. 25,233

October 16, 2012

PORTION OF
FORMER POHUKAINA SCHOOL LOT

Kaakaukukui, Honolulu, Oahu, Hawaii

Being a portion of Royal Patent 4483, Land Commission Award 7712, Apana 6, Part 1 to M. Kekuanaoa for V. Kamamalu conveyed to the Territory of Hawaii by the Trustees Under the Will and of the Estate of Bernice Pauahi Bishop, Deceased dated May 20, 1910 and recorded in Liber 326, Pages 459 to 461 (Land Office Deed 1227).

Beginning at the north corner of this parcel of land and on the southeast side of Keawe Street, the coordinates of said point of beginning referred to Government Survey Triangulation Station "PUNCHBOWL" being 4265.96 feet South and 3455.61 feet West, thence running by azimuths measured clockwise from True South:-

1. 320° 30' 350.00 feet along Part 2 of Halekauwila Place, Governor's Executive Order 4345;
2. 50° 30' 269.78 feet along the northwest side of Coral Street;
3. 140° 30' 350.00 feet along the northeast side of Pohukaina Street;



4. 230° 30' 269.78 feet along the southeast side of Keawe Street to the point of beginning and containing an AREA OF 94,423 SQUARE FEET.

SUBJECT, HOWEVER, to the following as shown on plan attached hereto and made a part hereof:

- 1. Perpetual Non-Exclusive Transformer Easement covered by Grant of Easement: State of Hawaii to Hawaiian Electric Company, Inc. dated October 18, 1994 and recorded as Document No. 95-011793 (Land Office Deed S-28063).
- 2. Future Road Rounding (30.00 Feet Radius) at the intersection of Keawe and Pohukaina Streets.
- 3. Future Road Rounding (30.00 Feet Radius) at the intersection of Coral and Pohukaina Streets.

SURVEY DIVISION
DEPARTMENT OF ACCOUNTING AND GENERAL SERVICES
STATE OF HAWAII

By: Gerald Z. Yonashiro
Gerald Z. Yonashiro
Land Surveyor ry

Compiled from CSF 25,013 and other Govt. Survey Records.



HALEKAUWILA STREET

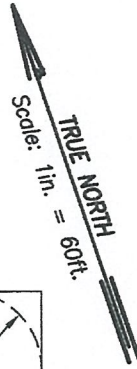

Portion of Former Pohukaina School Lot (C.S.F. 25,014)

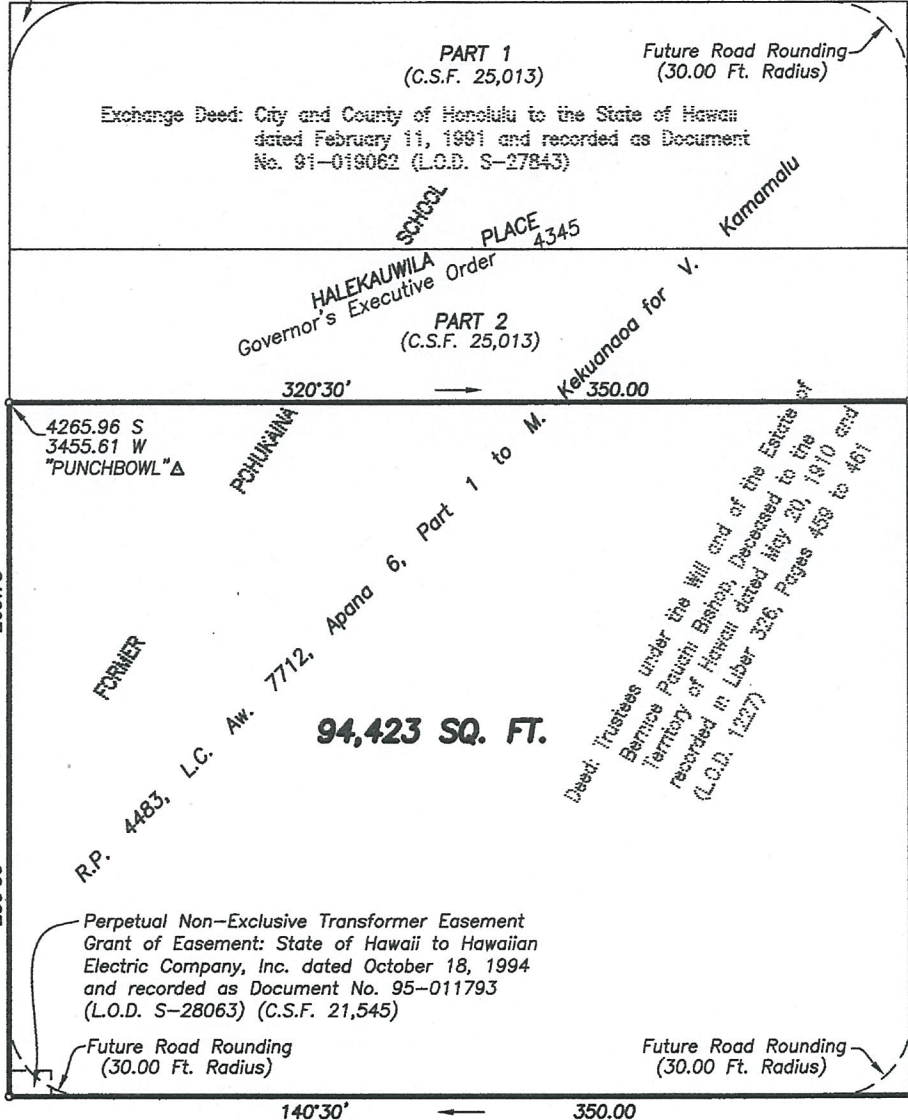

KEAWE STREET

CORAL STREET

POHUKAINA STREET

REDUCED NOT TO SCALE



PORTION OF FORMER POHUKAINA SCHOOL LOT

Kaakaukukui, Honolulu, Oahu, Hawaii

Job O-220(12)
C. Bk.

Scale: 1 inch = 60 feet

EXHIBIT "B"

TAX MAP: 2-1-51: 41

SURVEY DIVISION
DEPARTMENT OF ACCOUNTING AND GENERAL SERVICES
STATE OF HAWAII

C.S.F. NO. 25,233

GZY October 16, 2012