



Aid Secondary Project S-0130(11), over and across Courses 1, 2, 4, 5, 6, 8 and 9, excepting and reserving therefrom to the State of Hawaii or its agents or assigns all roads and trails and other right-of-way for ingress, egress and regress at all times and for all purposes with or without vehicles and animals over the land herein described, or any part thereof, such rights of way to be designated by the State of Hawaii, Department of Land and Natural Resources, more particularly described in Exhibit "A" and delineated on Exhibit "B," both of which are attached hereto and made parts hereof, said exhibits being respectively, a survey description and survey map prepared by the Survey Division, Department of Accounting and General Services, State of Hawaii, both being designated C.S.F. No. 25,645 and dated January 4, 2018.

SUBJECT, HOWEVER, to the condition that upon cancellation of this executive order or in the event of non-use or abandonment of the premises or any portion thereof for a continuous period of one (1) year, or for any reason whatsoever, the State of Hawaii, Department of Agriculture shall, within a reasonable time, restore the premises to a condition satisfactory and acceptable to the Department of Land and Natural Resources, State of Hawaii.

SUBJECT, FURTHER, to disapproval by the Legislature by two-thirds vote of either the Senate or the House of Representatives or by majority vote of both, in any regular or special session next following the date of this Executive Order.

This executive order does not authorize the recipient of the set aside to sell or exchange or otherwise relinquish the State of Hawaii's title to the subject public land.

IN WITNESS WHEREOF, I have hereunto set my hand and caused the Great Seal of the State of Hawaii to be affixed. Done at the Capitol at Honolulu this 6<sup>th</sup> day of March, 2018.



DAVID Y. IGE  
Governor of the State of Hawaii

APPROVED AS TO FORM:

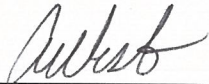

AMANDA J. WESTON  
Deputy Attorney General

Dated: February 14, 2018



STATE OF HAWAII

Office of the Lieutenant Governor

THIS IS TO CERTIFY That the within is a true copy of  
Executive Order No. 4546 setting aside land for public  
purposes, the original of which is on file in this office.

IN TESTIMONY WHEREOF, the Lieutenant  
Governor of the State of Hawaii, has  
hereunto subscribed his name and caused  
the Great Seal of the State to be affixed.



DOUGLAS S. CHIN

Lieutenant Governor of the State of Hawaii

DONE in Honolulu, this 13th day of  
March, A.D. 2018

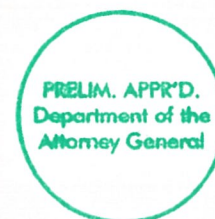



STATE OF HAWAII  
SURVEY DIVISION  
DEPARTMENT OF ACCOUNTING AND GENERAL SERVICES  
HONOLULU

C.S.F. No. 25,645

January 4, 2018

AGRICULTURAL PURPOSES SITE

Kaimu, Puna, Island of Hawaii, Hawaii

Being a portion of the Government (Crown) Land of Kaimu including Lots 18 and 19 of Kaimu-Makena Homesteads.

Beginning at the southeast corner of this parcel of land, on the southwest side of 30-Foot Road Reserve and on the northwest side of Kaimu-Pahoa Road, Federal Aid Secondary Project S-0130(11), the coordinates of said point of beginning referred to Government Survey Triangulation Station "HAKUMA" being 12,508.49 feet North and 6135.01 feet East, thence running by azimuths measured clockwise from True South:-

1. 38° 42' 319.57 feet along the northwest side of Kaimu-Pahoa Road, F.A.S.P. S-0130(11);
2. Thence along the northwest side of Kaimu-Pahoa Road, F.A.S.P. S-0130(11) on a curve to the left with a radius of 3879.72 feet, the chord azimuth and distance being:  
37° 07' 32.5" 213.18 feet;

PRELIM. APPR'D.  
Department of the  
Attorney General

3. Thence along the northwest side of Kaimu-Pahoa Road, F.A.S.P. S-0130(11) on a curve to the left with a radius of 3879.72 feet, the chord azimuth and distance being:  
35° 10' 56" 50.00 feet;
4. Thence along the northwest side of Kaimu-Pahoa Road, F.A.S.P. S-0130(11) on a curve to the left with a radius of 3879.72 feet, the chord azimuth and distance being:  
25° 46' 32" 1218.86 feet;
5. 286° 44' 17" 5.00 feet along a jog on the northwest side of Kaimu-Pahoa Road, F.A.S.P. S-0130(11);
6. Thence along the northwest side of Kaimu-Pahoa Road, F.A.S.P. S-0130(11) on a curve to the left with a radius of 3874.72 feet, the chord azimuth and distance being:  
15° 20' 52.5" 188.00 feet;
7. Thence along the northwest side of Kaimu-Pahoa Road, F.A.S.P. S-0130(11) on a curve to the left with a radius of 3874.72 feet, the chord azimuth and distance being:  
13° 35' 17" 50.01 feet;
8. Thence along the northwest side of Kaimu-Pahoa Road, F.A.S.P. S-0130(11) on a curve to the left with a radius of 3874.72 feet, the chord azimuth and distance being:  
11° 04' 03" 290.84 feet;
9. 8° 55' 491.32 feet along the northwest side of Kaimu-Pahoa Road, F.A.S.P. S-0130(11);
10. 144° 08' 5340.36 feet along Grant 10,528 to Kaamoku Waipa, Jr. and Grant 9961 to (Mrs.) Rosalie Alana Ahi Kaluhikaua;
11. 56° 50' 1034.90 feet along Grant 9961 to (Mrs.) Rosalie Alana Ahi Kaluhikaua;
12. 152° 19' 2168.70 feet along the northeast side of 30-Foot Road Reserve;
13. 62° 15' 30.00 feet along the northwest side of 30-Foot Road Reserve;
14. 152° 15' 3970.00 feet along Lot 15 of Kaimu-Makena Homesteads and Grant 9911 to Mulihehe Aienui or her heirs;



- 15. Thence along the south side of Upper Puna Government Road, the direct azimuth and distance being:  
236° 26' 27" 4324.30 feet;
- 16. 334° 05' 5407.40 feet along Lot 20 of Kikala-Keokea Homesteads, Grant 8539 to Sam Kaaukai or his heirs and Grant 8296 to John S. Kamelamela;
- 17. 6° 45' 55.60 feet along the west side of 30-Foot Road Reserve;
- 18. 334° 05' 1781.98 feet along the southwest side of 30-Foot Road Reserve;
- 19. 334° 00' 2770.76 feet along the southwest side of 30-Foot Road Reserve to the point of beginning and containing an AREA OF 816 ACRES, MORE OR LESS.

Vehicle access shall not be permitted into and from Kaimu-Pahoa Road, Federal Aid Secondary Project S-0130(11), over and across Courses 1, 2, 4, 5, 6, 8 and 9 of the above-described parcel of land.

Excepting and reserving therefrom to the State of Hawaii or its agents or assigns all roads and trails and other right-of-way for ingress, egress and regress at all times and for all purposes with or without vehicles and animals over the land herein described, or any part thereof, such rights of way to be designated by the Department of Land and Natural Resources.

SURVEY DIVISION  
DEPARTMENT OF ACCOUNTING AND GENERAL SERVICES  
STATE OF HAWAII

By: Gerald Z. Yonashiro  
Gerald Z. Yonashiro  
Land Surveyor rk

Compiled from CSF 20,085 and other Govt. Survey Records.



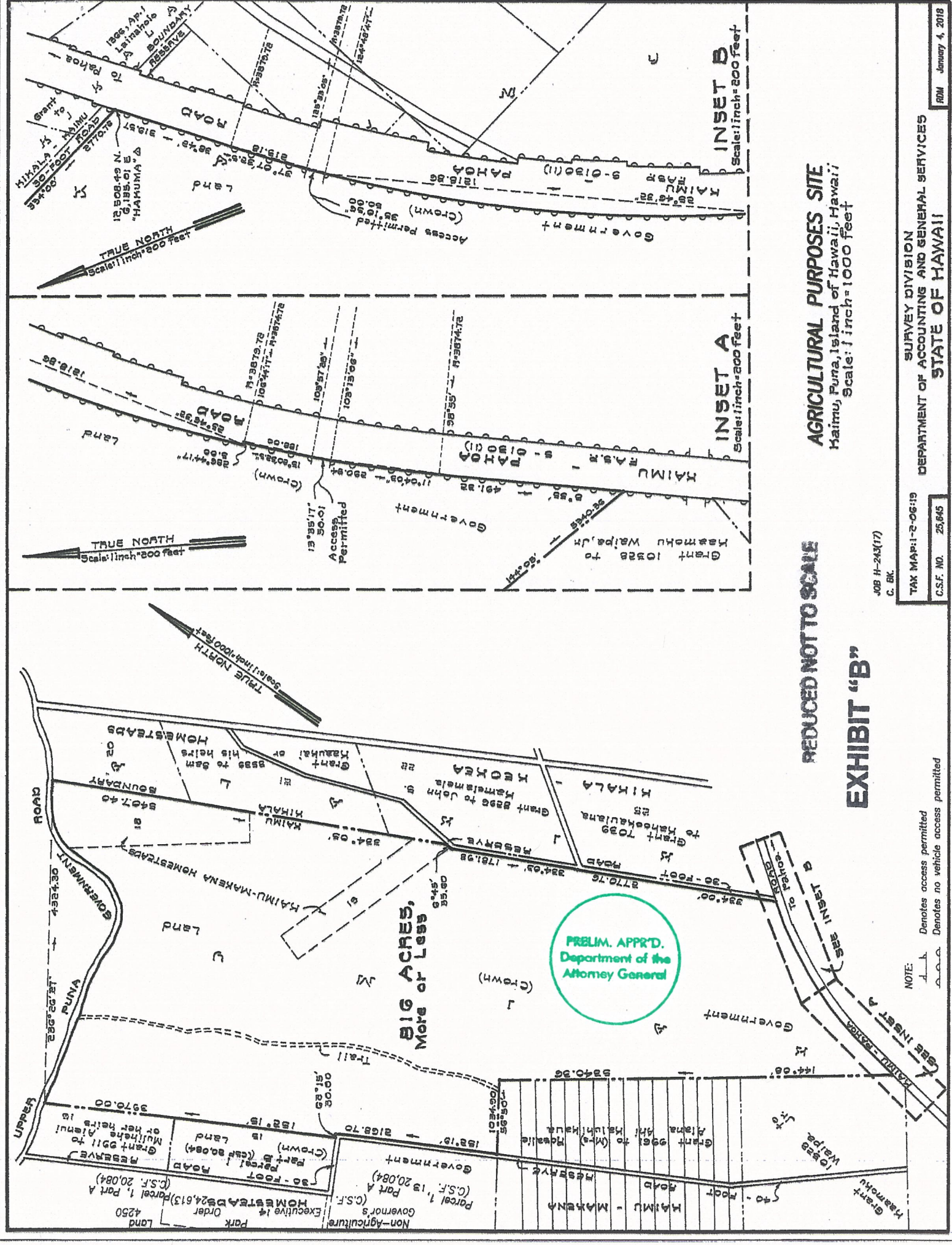

**REDUCED NOT TO SCALE**

**EXHIBIT "B"**

**AGRICULTURAL PURPOSES SITE**  
 Haimu, Puna, Island of Hawaii, Hawaii  
 Scale: 1 inch = 1000 feet

JOB H-243(17)  
 C. BK.

TAX MAP: 1-2-06:19  
 SURVEY DIVISION  
 DEPARTMENT OF ACCOUNTING AND GENERAL SERVICES  
 STATE OF HAWAII

NOTE:  
 --- Denotes access permitted  
 --- Denotes no vehicle access permitted