

identified as "Polipoli Spring State Recreation Area," containing an area of 7.970 acres, SUBJECT, HOWEVER, to a portion of easement for Pipe Line Right-of-Way (25 ft. wide), more particularly described in Exhibit "A" and delineated on Exhibit "B," both of which are attached hereto and made parts hereof, said exhibits being respectively, a survey description and survey map prepared by the Survey Division, Department of Accounting and General Services, State of Hawaii, both being designated C.S.F. No. 25,647 and dated January 12, 2018.

SUBJECT, HOWEVER, to the condition that upon cancellation of this executive order or in the event of non-use or abandonment of the premises or any portion thereof for a continuous period of one (1) year, or for any reason whatsoever, the State of Hawaii, Department of Land and Natural Resources, Division of State Parks shall, within a reasonable time, restore the premises to a condition satisfactory and acceptable to the Department of Land and Natural Resources, State of Hawaii.

SUBJECT, FURTHER, to disapproval by the Legislature by two-thirds vote of either the Senate or the House of Representatives or by majority vote of both, in any regular or special session next following the date of this Executive Order.

This executive order does not authorize the recipient of the set aside to sell or exchange or otherwise relinquish the State of Hawaii's title to the subject public land.

IN WITNESS WHEREOF, I have hereunto set my hand and caused the Great Seal of the State of Hawaii to be affixed. Done at the Capitol at Honolulu this 6th day of March, 2018.

David Y. Ige

DAVID Y. IGE
Governor of the State of Hawaii

VEN

APPROVED AS TO FORM:

Amanda J. Weston

AMANDA J. WESTON
Deputy Attorney General

Dated: February 9, 2018



STATE OF HAWAII

Office of the Lieutenant Governor

THIS IS TO CERTIFY That the within is a true copy of Executive Order No. 4549 setting aside land for public purposes, the original of which is on file in this office.

IN TESTIMONY WHEREOF, the Lieutenant Governor of the State of Hawaii, has hereunto subscribed his name and caused the Great Seal of the State to be affixed.

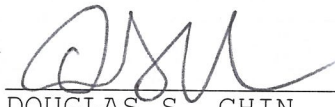

DOUGLAS S. CHIN
Lieutenant Governor of the State of Hawaii

DONE in Honolulu, this 13th day of March, A.D. 2018





STATE OF HAWAII
SURVEY DIVISION
DEPARTMENT OF ACCOUNTING AND GENERAL SERVICES
HONOLULU

C.S.F. No. 25,647

January 12, 2018

POLIPOLI SPRING STATE RECREATION AREA

Kamaole, Makawao, Maui, Hawaii

Being a portion of the Government Land of Kamaole.

Beginning at the northwesterly corner of this parcel of land, the coordinates of said point of beginning referred to Government Survey Triangulation Station "PUU O KALI" being 18,531.86 feet South and 18,822.08 feet East, thence running by azimuths measured clockwise from True South:-

1. 244° 09' 175.50 feet along Kula Forest Reserve, Governor's Proclamation dated September 11, 1912;
2. 303° 36' 181.52 feet along Kula Forest Reserve, Governor's Proclamation dated September 11, 1912;
3. 334° 32' 217.42 feet along Kula Forest Reserve, Governor's Proclamation dated September 11, 1912;
4. 322° 13' 105.68 feet along Kula Forest Reserve, Governor's Proclamation dated September 11, 1912;



5. 338° 30' 128.39 feet along Kula Forest Reserve, Governor's Proclamation dated September 11, 1912;
6. 292° 36' 90.10 feet along Kula Forest Reserve, Governor's Proclamation dated September 11, 1912;
7. 348° 43' 132.88 feet along Kula Forest Reserve, Governor's Proclamation dated September 11, 1912;
8. 8° 37' 111.70 feet along Kula Forest Reserve, Governor's Proclamation dated September 11, 1912;
9. 312° 45' 46.96 feet along Kula Forest Reserve, Governor's Proclamation dated September 11, 1912;
10. 302° 34' 37.29 feet along Kula Forest Reserve, Governor's Proclamation dated September 11, 1912;
11. 305° 38' 56.97 feet along Kula Forest Reserve, Governor's Proclamation dated September 11, 1912;
12. 15° 11' 133.92 feet along Kula Forest Reserve, Governor's Proclamation dated September 11, 1912;
13. 324° 55' 103.85 feet along Kula Forest Reserve, Governor's Proclamation dated September 11, 1912;
14. 342° 59' 101.03 feet along Kula Forest Reserve, Governor's Proclamation dated September 11, 1912;
15. 83° 11' 45.20 feet along Kula Forest Reserve, Governor's Proclamation dated September 11, 1912;
16. 76° 47' 106.51 feet along Kula Forest Reserve, Governor's Proclamation dated September 11, 1912;
17. 132° 08' 67.69 feet along Kula Forest Reserve, Governor's Proclamation dated September 11, 1912;
18. 138° 29' 222.98 feet along Kula Forest Reserve, Governor's Proclamation dated September 11, 1912;
19. 163° 12' 247.56 feet along Kula Forest Reserve, Governor's Proclamation dated September 11, 1912;



- 20. 126° 15' 58.77 feet along Kula Forest Reserve, Governor's Proclamation dated September 11, 1912;
- 21. 178° 20' 91.23 feet along Kula Forest Reserve, Governor's Proclamation dated September 11, 1912;
- 22. 140° 13' 402.97 feet along Kula Forest Reserve, Governor's Proclamation dated September 11, 1912;
- 23. 168° 50' 243.91 feet along Kula Forest Reserve, Governor's Proclamation dated September 11, 1912 to the point of beginning and containing an AREA OF 7.970 ACRES.

SUBJECT, HOWEVER, to a portion of easement for Pipe Line Right-of-Way (25 ft. wide) as shown on plan attached hereto and made a part hereof.

SURVEY DIVISION
DEPARTMENT OF ACCOUNTING AND GENERAL SERVICES
STATE OF HAWAII

By: Sea 3. Yonashiro
Gerald Z. Yonashiro
Land Surveyor rk

Compiled from map and desc. furn. by Akamai Land Surveying, Inc. Said map and desc. have been examined and checked as to form and mathematical correctness but not on the ground by the Survey Division.



TRUE NORTH
SCALE: 1 in. = 100 ft.

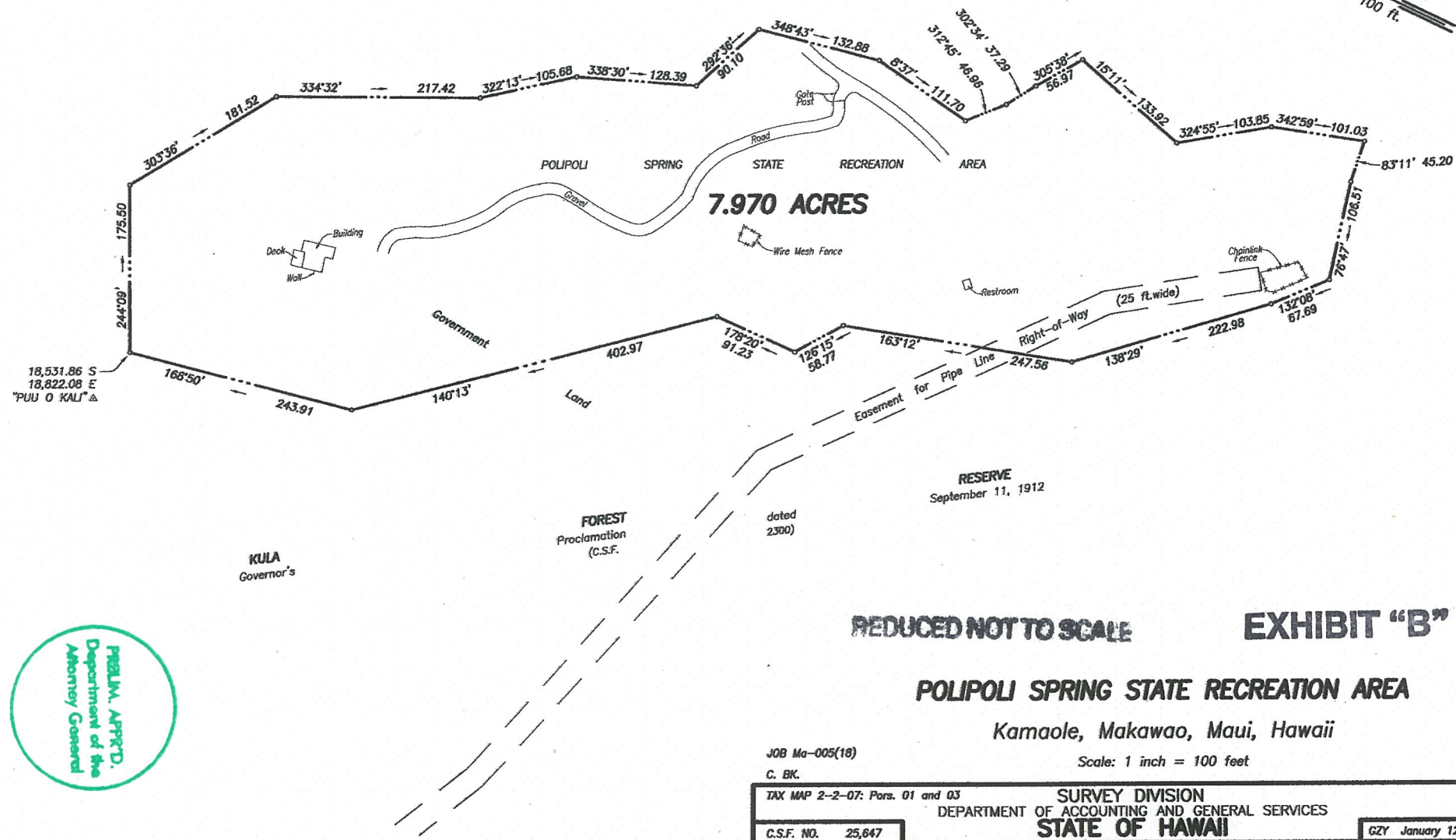

REDUCED NOT TO SCALE

EXHIBIT "B"

POLIPOLI SPRING STATE RECREATION AREA

Kamaole, Makawao, Maui, Hawaii

JOB Ma-005(18)
C. BK.

Scale: 1 inch = 100 feet

TAX MAP 2-2-07: Pars. 01 and 03	SURVEY DIVISION
C.S.F. NO. 25,647	DEPARTMENT OF ACCOUNTING AND GENERAL SERVICES
	STATE OF HAWAII
	GZY January 12, 2018