

site, more particularly described in Exhibit "A" and delineated on Exhibit "B," both of which are attached hereto and made parts hereof, said exhibits being respectively, a survey description and survey map prepared by the Survey Division, Department of Accounting and General Services, State of Hawaii, both being designated C.S.F. No. 25,655 and dated March 7, 2018.

SUBJECT, HOWEVER, to the condition that upon cancellation of this executive order or in the event of non-use or abandonment of the premises or any portion thereof for a continuous period of one (1) year, or for any reason whatsoever, the City and County of Honolulu shall, within a reasonable time, restore the premises to a condition satisfactory and acceptable to the Department of Land and Natural Resources, State of Hawaii.

SUBJECT, FURTHER, to disapproval by the Legislature by two-thirds vote of either the Senate or the House of Representatives or by majority vote of both, in any regular or special session next following the date of this Executive Order.

This executive order does not authorize the recipient of the set aside to sell or exchange or otherwise relinquish the State of Hawaii's title to the subject public land.

IN WITNESS WHEREOF, I have hereunto set my hand and caused the Great Seal of the State of Hawaii to be affixed. Done at the Capitol at Honolulu this 12th day of April, 2018.

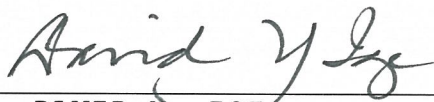

DAVID Y. IGE
Governor of the State of Hawaii

APPROVED AS TO FORM:



CINDY Y. YOUNG
Deputy Attorney General

Dated: April 2, 2018



STATE OF HAWAII

Office of the Lieutenant Governor

THIS IS TO CERTIFY That the within is a true copy of Executive Order No. 4554 setting aside land for public purposes, the original of which is on file in this office.

IN TESTIMONY WHEREOF, the Lieutenant Governor of the State of Hawaii, has hereunto subscribed his name and caused the Great Seal of the State to be affixed.

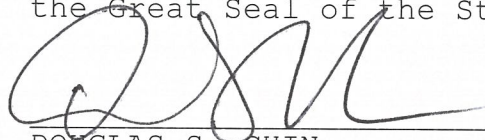

DOUGLAS S. CHIN

Lieutenant Governor of the State of Hawaii

DONE in Honolulu, this 18 day of
APR, A.D. 2018





STATE OF HAWAI'I
SURVEY DIVISION
DEPARTMENT OF ACCOUNTING AND GENERAL SERVICES
HONOLULU

C.S.F. No. 25,655

March 7, 2018

FIRE STATION AND ALLIED PURPOSES SITE

Manana-nui, Ewa, Oahu, Hawaii

Being a portion of Land Patent 8168, Land Commission Award 8305, Apana 2, Part 12 to Paulo Kanoa (Certificate of Boundaries 108) conveyed to the Territory of Hawaii, comprising the following:

- A. Lot 1 of Block 1 of Pearl City Lots conveyed to the Territory of Hawaii by Anna L. Mcguire by deed dated July 24, 1913 and recorded in Liber 378, Page 244 (Land Office Deed 1719).
- B. Portion of Lot 2 of Block 1 of Pearl City Lots conveyed to the Territory of Hawaii by Trent Trust Company, Ltd. (Trustee) by deed dated July 21, 1913 and recorded in Liber 378, Page 245 (Land Office Deed 1718).
- C. Portion of Lot 5 of Block 1 of Pearl City Lots conveyed to the Territory of Hawaii by William R. Castle to Territory of Hawaii by deed dated July 29, 1913 and recorded in Liber 378, Page 246 (Land Office Deed 1720).

Beginning at the northwest corner of this parcel of land, at the southwest corner of Parcel 27, Governor's Executive Order 2407, on the southeast side of Lehua Avenue and on the southwest side of Interstate Highway, Federal Aid Project No. I-H1-1 (13), the coordinates of said point of beginning referred to Government Survey Triangulation Station "EWA CHURCH" being 569.43 feet South and 2934.01 feet East, thence running by azimuths measured clockwise from True South:-

PRELIM. APPR'D.
Department of the
Attorney General

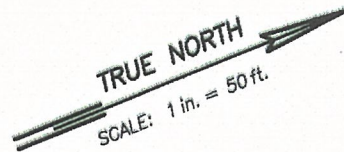

LEHUA

AVENUE

L. P. to

FIRST STREET

569.43 S
2934.01 E
"EWA CHURCH" Δ

202'00" → 85.87

112'00" → 225.00

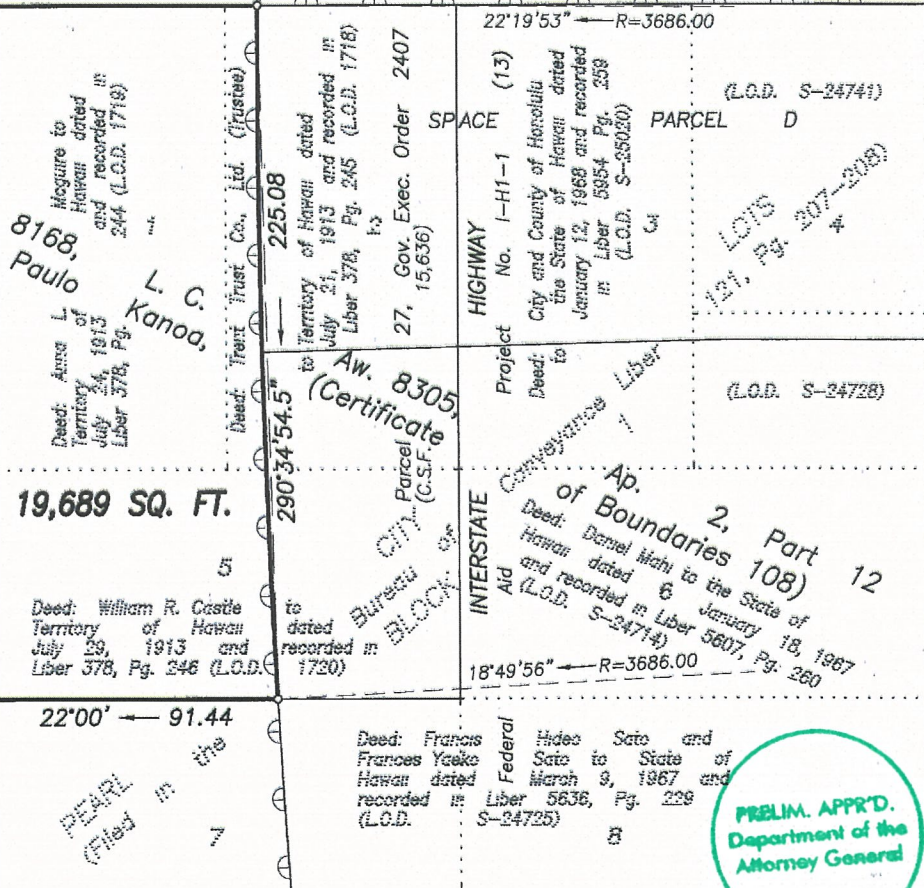

Deed: Anna L. McGuire to Territory of Hawaii dated July 24, 1913 and recorded in Liber 378, Pg. 244 (L.O.D. 1718)

Deed: William R. Castle Territory of Hawaii July 29, 1913 and Liber 378, Pg. 246 (L.O.D. 1720)

Deed: Territory of Hawaii dated July 21, 1913 and recorded in Liber 378, Pg. 245 (L.O.D. 1718) to Gov. Exec. Order 2407 27, 15,636

Deed: Francis Frances Yaeke Hawaii dated March 9, 1967 and recorded in Liber 5636, Pg. 229 (L.O.D. S-24725)

Deed: Daniel Mahi to the State of Hawaii dated January 18, 1967 and recorded in Liber 5607, Pg. 260 (L.O.D. S-24714)

Deed: Daniel Mahi to the State of Hawaii dated January 18, 1967 and recorded in Liber 5607, Pg. 260 (L.O.D. S-24714)

PRELIM. APPR'D.
Department of the Attorney General

FIRE STATION AND ALLIED PURPOSES SITE

Manana-nui, Ewa, Oahu, Hawaii

Scale: 1 inch = 50 feet

EXHIBIT "B"

REDUCED NOT TO SCALE

Denotes limited access.
Denotes no access permitted

JOB O-256(17)
C. BK.

TAX MAP 9-7-20:04

SURVEY DIVISION
DEPARTMENT OF ACCOUNTING AND GENERAL SERVICES
STATE OF HAWAII

C.S.F. NO. 25,655

DM March 7, 2018