

)

)

)

)

)

)

)

)

)

)

)

)

)

)

)

)

 LAND COURT SYSTEM) REGULAR SYSTEM

 Return by Mail () Pickup () To:

Total Number of Pages:

Tax Map Key No. (4) 3-9-001:002 (portion)

FROM: AGRIBUSINESS DEVELOPMENT CORPORATION,
 a public body corporate and politic and an
 instrumentality and agency of the State of Hawaii

TO: STATE OF HAWAII
 BOARD OF LAND AND NATURAL RESOURCES
 1151 Punchbowl Street
 Honolulu, Hawaii 96813

 4594

EXECUTIVE ORDER NO. _____

WITHDRAWING LAND FROM THE OPERATION OF
 GOVERNOR'S EXECUTIVE ORDER NO. 4328
 DATED AUGUST 24, 2010

WHEREAS, by Governor's Executive Order No. 4328 dated August 24, 2010, certain land and improvements situate at Wailua, Lihue, Kauai, Hawaii was set aside to be under the control and management of the Agribusiness Development Corporation, a public body corporate and politic and an instrumentality and agency of the State of Hawaii; and

WHEREAS, the Board of Land and Natural Resources, at



its meeting of March 24, 2011, approved the withdrawal of portions of land and improvements from Executive Order No. 4328 dated August 24, 2010.

NOW, THEREFORE, I, DAVID Y. IGE, Governor of the State of Hawaii, by virtue of the authority vested in me under Section 171-11, Hawaii Revised Statutes, as amended, do hereby order that the following described land and improvements, identified as "Withdrawal Portions of Wailua Agricultural and Related Purposes Site, Governor's Executive Order 4328, Parts 1, 2 and 3, situate at Wailua, Lihue, Kauai, Hawaii, consisting of:

Part 1 containing an area of 61.056 acres,

Part 2 containing an area of 7.454 acres, and

Part 3 containing an area of 0.020 acre,

more particularly described in Exhibit "A" and delineated on Exhibit "B," both of which are attached hereto and made parts hereof, said exhibits being respectively, a survey description and survey map prepared by the Survey Division, Department of Accounting and General Services, State of Hawaii, being designated as C.S.F. No. 25,610 and dated June 30, 2017, is hereby withdrawn from the Operation of Governor's Executive Order No. 4328 dated August 24, 2010.

SUBJECT to disapproval by the Legislature by two-thirds vote of either the Senate or the House of Representatives or by majority vote of both, in any regular or special session next following the date of this Executive Order.

IN WITNESS WHEREOF, I have hereunto set my hand and caused the Great Seal of the State of Hawaii to be affixed. Done at the Capitol at Honolulu this 11th day of September, 2019.

APPROVED AS TO FORM:

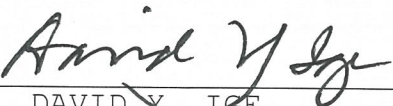

DAVID Y. IGE
Governor of the State of Hawaii



JULIE H. CHINA
Deputy Attorney General

Dated: August 19, 2019



STATE OF HAWAII

Office of the Lieutenant Governor

THIS IS TO CERTIFY That the within is a true copy of Executive Order No. 4594 withdrawing land and improvements from the operation of Executive Order No. 4328, the original of which is on file in this office.

IN TESTIMONY WHEREOF, the Lieutenant Governor of the State of Hawaii, has hereunto subscribed his name and caused the Great Seal of the State to be affixed.

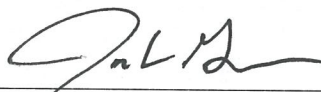

JOSH GREEN

Lieutenant Governor of the State of Hawaii

DONE in Honolulu, this 19th day of September, A.D. 2019



STATE OF HAWAI'I
SURVEY DIVISION
DEPARTMENT OF ACCOUNTING AND GENERAL SERVICES
HONOLULU

C.S.F. No. 25,610

June 30, 2017

WITHDRAWAL
PORTIONS OF WAILUA AGRICULTURAL AND RELATED PURPOSES SITE
Governor's Executive Order 4328

PARTS 1, 2 AND 3

Wailua, Lihue, Kauai, Hawaii

Being portions of the Government (Crown) Land of Wailua.

PART 1

Beginning at the northwest corner of this parcel of land and at the southwest corner of Lihue-Koloa Forest Reserve, Governor's Executive Order 3804, the coordinates of said point of beginning referred to Government Survey Triangulation Station "NONOU" being 3206.51 feet South and 26,198.38 feet West, thence running by azimuths measured clockwise from True South:-

- | | | |
|----|----------|---|
| 1. | 305° 00' | 160.00 feet along Lihue-Koloa Forest Reserve,
Governor's Executive Order 3804; |
| 2. | 296° 00' | 220.00 feet along Lihue-Koloa Forest Reserve,
Governor's Executive Order 3804; |
| 3. | 288° 00' | 225.00 feet along Lihue-Koloa Forest Reserve,
Governor's Executive Order 3804; |
| 4. | 301° 00' | 160.00 feet along Lihue-Koloa Forest Reserve,
Governor's Executive Order 3804; |

PRELIM. APPR'D.
Department of the
Attorney General

5.	290° 00'	110.00 feet along Lihue-Koloa Forest Reserve, Governor's Executive Order 3804;
6.	180° 00'	150.00 feet along Lihue-Koloa Forest Reserve, Governor's Executive Order 3804;
7.	150° 00'	250.00 feet along Lihue-Koloa Forest Reserve, Governor's Executive Order 3804;
8.	205° 00'	90.00 feet along Lihue-Koloa Forest Reserve, Governor's Executive Order 3804;
9.	250° 00'	410.00 feet along Lihue-Koloa Forest Reserve, Governor's Executive Order 3804;
10.	166° 00'	110.00 feet along Lihue-Koloa Forest Reserve, Governor's Executive Order 3804;
11.	185° 00'	70.00 feet along Lihue-Koloa Forest Reserve, Governor's Executive Order 3804;
12.	200° 00'	50.00 feet along Lihue-Koloa Forest Reserve, Governor's Executive Order 3804;
13.	212° 00'	110.00 feet along Lihue-Koloa Forest Reserve, Governor's Executive Order 3804;
14.	222° 00'	200.00 feet along Lihue-Koloa Forest Reserve, Governor's Executive Order 3804;
15.	200° 00'	100.00 feet along Lihue-Koloa Forest Reserve, Governor's Executive Order 3804;
16.	253° 00'	170.00 feet along Lihue-Koloa Forest Reserve, Governor's Executive Order 3804;
17.	319° 00'	230.00 feet along Lihue-Koloa Forest Reserve, Governor's Executive Order 3804;
18.	22° 00'	300.00 feet along Lihue-Koloa Forest Reserve, Governor's Executive Order 3804;
19.	336° 00'	185.00 feet along Lihue-Koloa Forest Reserve, Governor's Executive Order 3804;



- | | | |
|-----|----------|---|
| 20. | 322° 00' | 360.00 feet along Lihue-Koloa Forest Reserve,
Governor's Executive Order 3804; |
| 21. | 256° 00' | 110.00 feet along Lihue-Koloa Forest Reserve,
Governor's Executive Order 3804; |
| 22. | 285° 00' | 100.00 feet along Lihue-Koloa Forest Reserve,
Governor's Executive Order 3804; |
| 23. | 307° 00' | 160.00 feet along Lihue-Koloa Forest Reserve,
Governor's Executive Order 3804; |
| 24. | 267° 00' | 150.00 feet along Lihue-Koloa Forest Reserve,
Governor's Executive Order 3804; |
| 25. | 298° 00' | 150.00 feet along Lihue-Koloa Forest Reserve,
Governor's Executive Order 3804; |
| 26. | 283° 00' | 130.00 feet along Lihue-Koloa Forest Reserve,
Governor's Executive Order 3804; |
| 27. | 259° 00' | 140.00 feet along Lihue-Koloa Forest Reserve,
Governor's Executive Order 3804; |
| 28. | 227° 00' | 160.00 feet along Lihue-Koloa Forest Reserve,
Governor's Executive Order 3804; |
| 29. | 244° 00' | 170.00 feet along Lihue-Koloa Forest Reserve,
Governor's Executive Order 3804; |
| 30. | 235° 00' | 130.00 feet along Lihue-Koloa Forest Reserve,
Governor's Executive Order 3804; |
| 31. | 226° 00' | 190.00 feet along Lihue-Koloa Forest Reserve,
Governor's Executive Order 3804; |
| 32. | 232° 00' | 260.00 feet along Lihue-Koloa Forest Reserve,
Governor's Executive Order 3804; |
| 33. | 257° 00' | 120.00 feet along Lihue-Koloa Forest Reserve,
Governor's Executive Order 3804; |
| 34. | 310° 00' | 110.00 feet along Lihue-Koloa Forest Reserve,
Governor's Executive Order 3804; |

- 35. 6° 00' 4.74 feet along the remainder of Wailua Agricultural and Related Purposes Site, Governor's Executive Order 4328;
- 36. 357° 03' 155.01 feet along the remainder of Wailua Agricultural and Related Purposes Site, Governor's Executive Order 4328;
- 37. 355° 23' 64.00 feet along the remainder of Wailua Agricultural and Related Purposes Site, Governor's Executive Order 4328;
- 38. 351° 42' 140.00 feet along the remainder of Wailua Agricultural and Related Purposes Site, Governor's Executive Order 4328;
- 39. 351° 30' 200.00 feet along the remainder of Wailua Agricultural and Related Purposes Site, Governor's Executive Order 4328;
- 40. 349° 45' 60.00 feet along the remainder of Wailua Agricultural and Related Purposes Site, Governor's Executive Order 4328;
- 41. 348° 00' 130.00 feet along the remainder of Wailua Agricultural and Related Purposes Site, Governor's Executive Order 4328;
- 42. 349° 22' 225.00 feet along the remainder of Wailua Agricultural and Related Purposes Site, Governor's Executive Order 4328;
- 43. 348° 35' 122.00 feet along the remainder of Wailua Agricultural and Related Purposes Site, Governor's Executive Order 4328;
- 44. 347° 45' 90.00 feet along the remainder of Wailua Agricultural and Related Purposes Site, Governor's Executive Order 4328;
- 45. 346° 00' 188.00 feet along the remainder of Wailua Agricultural and Related Purposes Site, Governor's Executive Order 4328;



46. 346° 30' 182.00 feet along the remainder of Wailua Agricultural and Related Purposes Site, Governor's Executive Order 4328;
47. 134° 30' 51.60 feet along the remainder of Wailua Agricultural and Related Purposes Site, Governor's Executive Order 4328;
48. 111° 50' 150.00 feet along the remainder of Wailua Agricultural and Related Purposes Site, Governor's Executive Order 4328;
49. 112° 06' 153.00 feet along the remainder of Wailua Agricultural and Related Purposes Site, Governor's Executive Order 4328;
50. 112° 42' 174.00 feet along the remainder of Wailua Agricultural and Related Purposes Site, Governor's Executive Order 4328;
51. 113° 33' 177.00 feet along the remainder of Wailua Agricultural and Related Purposes Site, Governor's Executive Order 4328;
52. 113° 23' 197.00 feet along the remainder of Wailua Agricultural and Related Purposes Site, Governor's Executive Order 4328;
53. 113° 24' 196.00 feet along the remainder of Wailua Agricultural and Related Purposes Site, Governor's Executive Order 4328;
54. 112° 55' 274.00 feet along the remainder of Wailua Agricultural and Related Purposes Site, Governor's Executive Order 4328;
55. 108° 33' 45.00 feet along the remainder of Wailua Agricultural and Related Purposes Site, Governor's Executive Order 4328;
56. 103° 07' 34.00 feet along the remainder of Wailua Agricultural and Related Purposes Site, Governor's Executive Order 4328;



- 57. 102° 08' 50.00 feet along the remainder of Wailua Agricultural and Related Purposes Site, Governor's Executive Order 4328;
- 58. 83° 30' 87.00 feet along the remainder of Wailua Agricultural and Related Purposes Site, Governor's Executive Order 4328;
- 59. 75° 33' 213.00 feet along the remainder of Wailua Agricultural and Related Purposes Site, Governor's Executive Order 4328;
- 60. 72° 37' 23.00 feet along the remainder of Wailua Agricultural and Related Purposes Site, Governor's Executive Order 4328;
- 61. 78° 27' 34.00 feet along the remainder of Wailua Agricultural and Related Purposes Site, Governor's Executive Order 4328;
- 62. 85° 13' 24.00 feet along the remainder of Wailua Agricultural and Related Purposes Site, Governor's Executive Order 4328;
- 63. 91° 28' 33.00 feet along the remainder of Wailua Agricultural and Related Purposes Site, Governor's Executive Order 4328;
- 64. 89° 42' 30.00 feet along the remainder of Wailua Agricultural and Related Purposes Site, Governor's Executive Order 4328;
- 65. 92° 45' 168.00 feet along the remainder of Wailua Agricultural and Related Purposes Site, Governor's Executive Order 4328;
- 66. 100° 00' 355.00 feet along the remainder of Wailua Agricultural and Related Purposes Site, Governor's Executive Order 4328;
- 67. 102° 00' 250.00 feet along the remainder of Wailua Agricultural and Related Purposes Site, Governor's Executive Order 4328;



Station "NONOU" being 2267.11 feet South and 22,582.36 feet West, thence running by

azimuths measured clockwise from True South:-

- | | | |
|-----|------------|---|
| 1. | 87° 00' | 8.72 feet along the remainder of Wailua Agricultural and Related Purposes Site, Governor's Executive Order 4328; |
| 2. | 183° 00' | 320.00 feet along Lihue-Koloa Forest Reserve, Governor's Executive Order 3804; |
| 3. | 176° 00' | 430.00 feet along Lihue-Koloa Forest Reserve, Governor's Executive Order 3804; |
| 4. | 186° 00' | 1100.00 feet along Lihue-Koloa Forest Reserve, Governor's Executive Order 3804; |
| 5. | 90° 00' | 190.00 feet along Lihue-Koloa Forest Reserve, Governor's Executive Order 3804; |
| 6. | 190° 00' | 400.00 feet along Lihue-Koloa Forest Reserve, Governor's Executive Order 3804; |
| 7. | 197° 00' | 200.00 feet along Lihue-Koloa Forest Reserve, Governor's Executive Order 3804; |
| 8. | 223° 00' | 180.00 feet along Lihue-Koloa Forest Reserve, Governor's Executive Order 3804; |
| 9. | 272° 00' | 118.44 feet along Lihue-Koloa Forest Reserve, Governor's Executive Order 3804; |
| 10. | 6° 04' 45" | 2569.17 feet along the remainder of Wailua Agricultural and Related Purposes Site, Governor's Executive Order 4328 to the point of beginning and containing an AREA OF 7.454 ACRES. |

PART 3

Beginning at the northeast corner of this parcel of land and at the easterly corner of Lihue-Koloa Forest Reserve, Governor's Executive Order 3804, the



coordinates of said point of beginning referred to Government Survey Triangulation

Station "NONOU" being 524.54 feet North and 22,252.05 feet West, thence running by

azimuths measured clockwise from True South:-

- 1. 30° 46' 20" 66.59 feet along the remainder of Wailua Agricultural and Related Purposes Site, Governor's Executive Order 4328;
- 2. 184° 00' 59.46 feet along Lihue-Koloa Forest Reserve, Governor's Executive Order 3804;
- 3. 274° 00' 30.00 feet along Lihue-Koloa Forest Reserve, Governor's Executive Order 3804 to the point of beginning and containing an AREA OF 0.020 ACRE.

SURVEY DIVISION
 DEPARTMENT OF ACCOUNTING AND GENERAL SERVICES
 STATE OF HAWAII

By: *Gerald Z. Yonashiro*
 Gerald Z. Yonashiro
 Land Surveyor rk

Compiled from map and desc.
 furn. by R.M. Towill Corporation.
 Said map and desc. have been
 examined and checked as to form
 and mathematical correctness but
 not on the ground by the Survey
 Division.



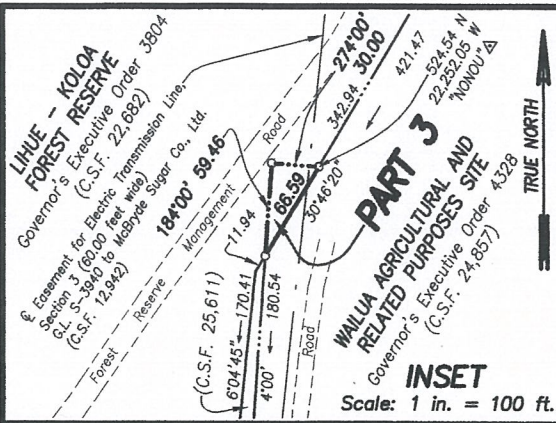

REDUCED NOT TO SCALE

Governor's Executive Order 3118
(C.S.F. 16,617)

Government

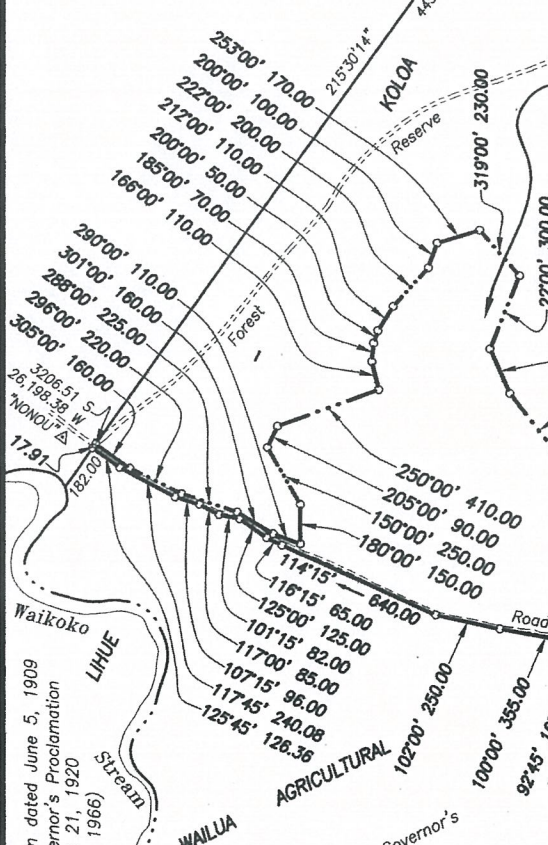

Governor's Executive Order 3804
(C.S.F. 22,682)

(Crown)

PART 2
7.454 ACRES

PART 3
0.020 ACRE

PART 1
61.056 ACRES

RELATED PURPOSES

AND

Executive
(C.S.F. 24,857)

WITHDRAWAL PORTIONS OF WAILUA AGRICULTURAL AND RELATED PURPOSES SITE
Governor's Executive Order 4328
PARTS 1, 2 AND 3

Wailua, Lihue, Kauai, Hawaii
Scale: 1 inch = 600 feet

PRELIM. APPR'D.
Department of the Attorney General

EXHIBIT "B"

TMK 3-9-01: Pors. 02

SURVEY DIVISION
DEPARTMENT OF ACCOUNTING AND GENERAL SERVICES
STATE OF HAWAII

C.S.F. NO. 25,610

MAC June 30, 2017