

WHEREAS, the Board of Land and Natural Resources at its meetings held on December 9, 2010 and May 24, 2019, approved the cancellation of the remaining portion of Governor's Executive Order No. 1795 dated August 13, 1957.

NOW, THEREFORE, I, DAVID Y. IGE, Governor of the State of Hawaii, by virtue of the authority vested in me under Section 171-11, Hawaii Revised Statutes, as amended, do hereby order that the remaining portion of Governor's Executive Order No. 1795 dated August 13, 1957, be and the same is hereby cancelled and declared of no force and effect.

SUBJECT to disapproval by the Legislature by two-thirds vote of either the Senate or the House of Representatives or by majority vote of both, in any regular or special session next following the date of this Executive Order.

IN WITNESS WHEREOF, I have hereunto set my hand and caused the Great Seal of the State of Hawaii to be affixed. Done at the Capitol at Honolulu this 28th day of October, 2019.



DAVID Y. IGE
Governor of the State of Hawaii

APPROVED AS TO FORM:



COLIN J. LAU
Deputy Attorney General

Dated: 9/19/19



STATE OF HAWAII

Office of the Lieutenant Governor

THIS IS TO CERTIFY That the within is a true copy of Executive Order No. 4601 cancelling the remaining portion of lands and improvements from the operation of Executive Order No. 1795, the original of which is on file in this office.

IN TESTIMONY WHEREOF, the Lieutenant Governor of the State of Hawaii, has hereunto subscribed his name and caused the Great Seal of the State to be affixed.

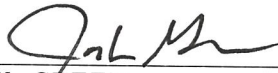

JOSH GREEN
Lieutenant Governor of the State of Hawaii

DONE in Honolulu, this 29th day of October, A.D. 2019



TRUE NORTH
SCALE: 1 in. = 300 ft.

ALA MOANA REEF AREA
(C.S.F. 12,696)

ALA MOANA
Transferred to the City and County of Honolulu August 18, 1928
Dead: State of Hawaii dated June 26, 1987 and recorded as Document No. 1997-085312 (C.S.F. 21,705)
Territory of Hawaii by Public Law 70-123 dated Congress (C.S.F. 12,885)

REDUCED NOT TO SCALE

120.864 ACRES

Transferred to the Territory of Hawaii by Presidential Proclamation 1856 dated October 27, 1928 (C.S.F. 5122)

PRELIM. APPRID.
Department of the
Attorney General

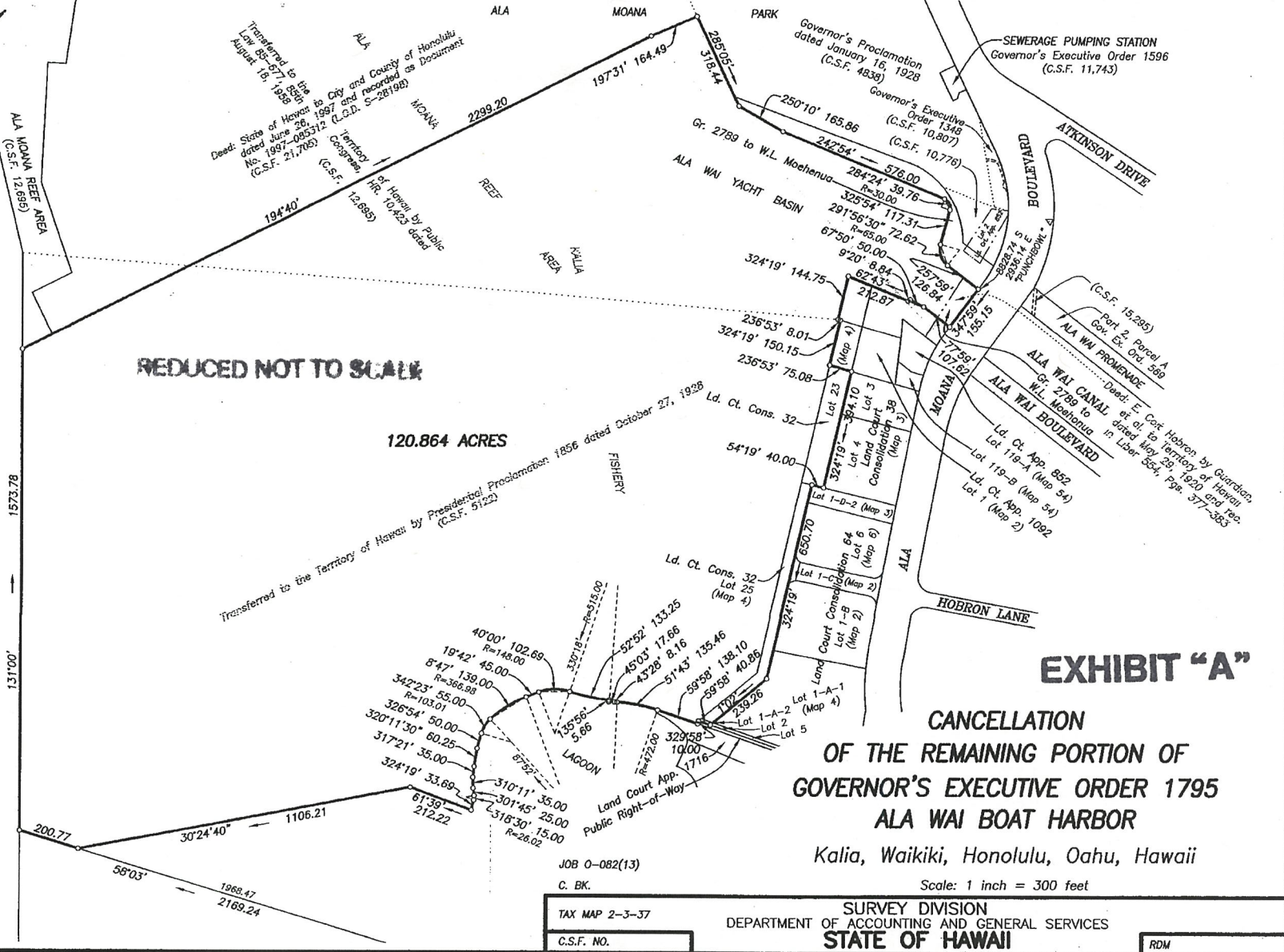

EXHIBIT "A"

**CANCELLATION
OF THE REMAINING PORTION OF
GOVERNOR'S EXECUTIVE ORDER 1795
ALA WAI BOAT HARBOR**

Kalia, Waikiki, Honolulu, Oahu, Hawaii

JOB O-082(13)
C. BK.

Scale: 1 inch = 300 feet

TAX MAP 2-3-37	SURVEY DIVISION
C.S.F. NO.	DEPARTMENT OF ACCOUNTING AND GENERAL SERVICES
	STATE OF HAWAII
	RDM