

meetings held on March 10, 2017 and May 10, 2019, approved the cancellation of Governor's Executive Order No. 1880 dated February 20, 1959.

NOW, THEREFORE, I, DAVID Y. IGE, Governor of the State of Hawaii, by virtue of the authority vested in me under Section 171-11, Hawaii Revised Statutes, as amended, do hereby order that Governor's Executive Order No. 1880 dated February 20, 1959, be and the same is hereby cancelled and declared of no force and effect.

SUBJECT to disapproval by the Legislature by two-thirds vote of either the Senate or the House of Representatives or by majority vote of both, in any regular or special session next following the date of this Executive Order.

IN WITNESS WHEREOF, I have hereunto set my hand and caused the Great Seal of the State of Hawaii to be affixed. Done at the Capitol at Honolulu this 20th day of October, 2019.



DAVID Y. IGE
Governor of the State of Hawaii

APPROVED AS TO FORM:



JULIE H. CHINA
Deputy Attorney General

Dated: Sept. 20, 2019



STATE OF HAWAII

Office of the Lieutenant Governor

THIS IS TO CERTIFY That the within is a true copy of Executive Order No. 4606 cancelling land from the operation of Executive Order No. 1880, the original of which is on file in this office.

IN TESTIMONY WHEREOF, the Lieutenant Governor of the State of Hawaii, has hereunto subscribed his name and caused the Great Seal of the State to be affixed.

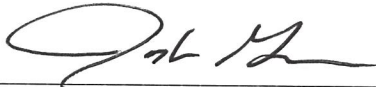

JOSH GREEN
Lieutenant Governor of the State of Hawaii

DONE in Honolulu, this 29th day of October, A.D. 2019



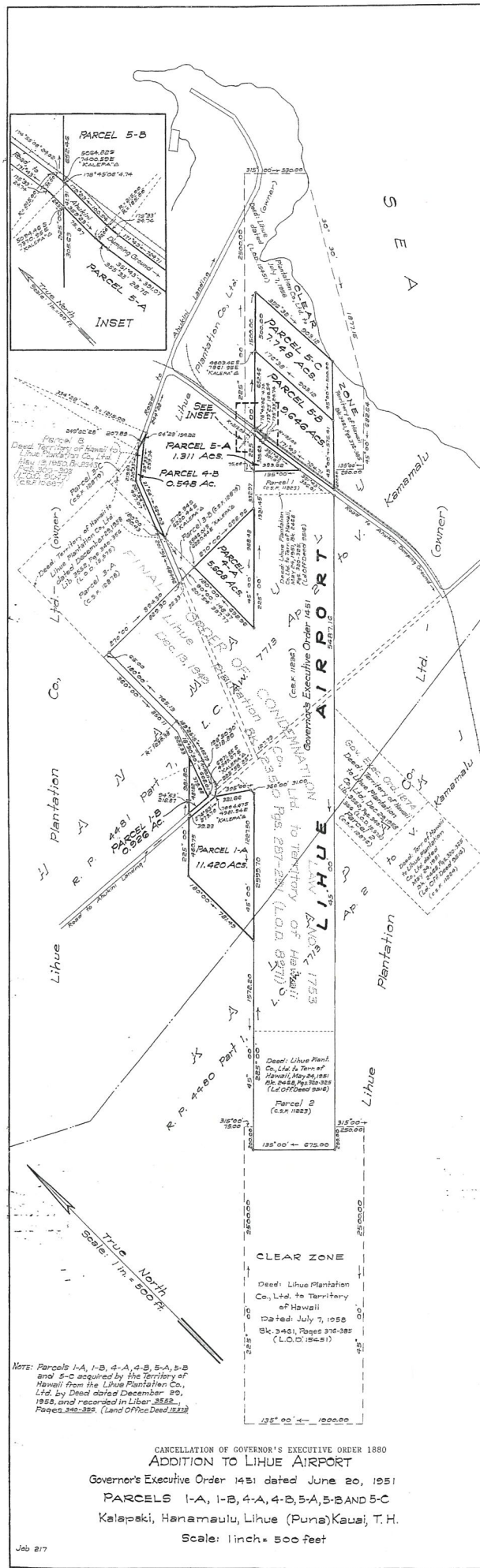

PRELIM. APPR'D.
Department of the
Attorney General

REDUCED NOT TO SCALE

EXHIBIT "A"

Note: Parcels 1-A, 1-B, 4-A, 4-B, 5-A, 5-B and 5-C acquired by the Territory of Hawaii from the Lihue Plantation Co., Ltd. by Deed dated December 20, 1955, and recorded in Liber 3855, Pages 385-389. (Land Office Deed 1812)

CANCELLATION OF GOVERNOR'S EXECUTIVE ORDER 1880
ADDITION TO LIHUE AIRPORT
Governor's Executive Order 1431 dated June 20, 1951
PARCELS 1-A, 1-B, 4-A, 4-B, 5-A, 5-B AND 5-C
Kalapaki, Hanamaulu, Lihue (Puna)Kauei, T.H.
Scale: 1 inch = 500 feet