



Hanalei and Waimea, Kauai, Hawaii, containing an area of 4000 square feet, TOGETHER WITH, Perpetual, Non-Exclusive Access and Utility Easement (20 ft. wide), more particularly described in Exhibit "A" and delineated on Exhibit "B," both of which are attached hereto and made parts hereof, said exhibits being respectively, a survey description and survey map prepared by the Survey Division, Department of Accounting and General Services, State of Hawaii, both being designated C.S.F. No. 25,760 and dated November 14, 2019, and

"Kukui Microwave Antenna Site," situate at Waimea, Kauai, Hawaii, containing an area of 1.251 acres, more particularly described in Exhibit "C" and delineated on Exhibit "D," both of which are attached hereto and made parts hereof, said exhibits being respectively, a survey description and survey map prepared by the Survey Division, Department of Accounting and General Services, State of Hawaii, both being designated C.S.F. No. 25,762 and dated November 14, 2019.

SUBJECT, HOWEVER, to:

1. The condition that upon cancellation of this executive order or in the event of non-use or abandonment of the premises or any portion thereof for a continuous period of one (1) year, or for any reason whatsoever, the State of Hawaii, Department of Accounting and General Services, Information and Communication Services Division shall, within a reasonable time, restore the premises to a condition satisfactory and acceptable to the Department of Land and Natural Resources, State of Hawaii.

2. The condition that the State of Hawaii, Department of Accounting and General Services, Information and Communication Services Division, accepts the subject land and improvements in an "as is" condition with all faults and defects, whether latent or patent.

3. The condition that if this set aside is cancelled in the future, the State of Hawaii, Department of Accounting and General Services, Information and Communication Services Division may be required to remove all improvements, restore the land to a condition satisfactory to the State of Hawaii, Department of Land and Natural Resources, and prepare a Phase I environmental site assessment.

SUBJECT, FURTHER, to disapproval by the Legislature by two-thirds vote of either the Senate or the House of Representatives or by majority vote of both, in any regular or special session next following the date of this Executive Order.

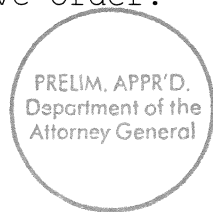

This executive order does not authorize the recipient of the set aside to sell or exchange or otherwise relinquish the State of Hawaii's title to the subject public land.

IN WITNESS WHEREOF, I have hereunto set my hand and caused the Great Seal of the State of Hawaii to be affixed. Done at the Capitol at Honolulu this 28<sup>th</sup> day of January, 2020.

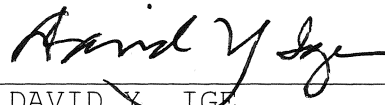

\_\_\_\_\_  
DAVID IGE  
Governor of the State of Hawaii

APPROVED AS TO FORM:

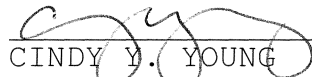

\_\_\_\_\_  
CINDY Y. YOUNG  
Deputy Attorney General

Dated: January 15, 2020

STATE OF HAWAII

Office of the Lieutenant Governor

THIS IS TO CERTIFY That the within is a true copy of Executive Order No. 4621 setting aside land and improvements for public purposes, the original of which is on file in this office.

IN TESTIMONY WHEREOF, the Lieutenant Governor of the State of Hawaii, has hereunto subscribed his name and caused the Great Seal of the State to be affixed.

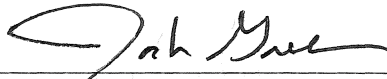

JOSH GREEN

Lieutenant Governor of the State of Hawaii

DONE in Honolulu, this 31<sup>st</sup> day of January, A.D. 2020

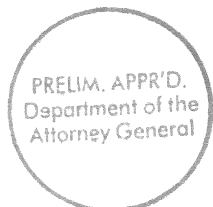



STATE OF HAWAII  
SURVEY DIVISION  
DEPARTMENT OF ACCOUNTING AND GENERAL SERVICES  
HONOLULU

C.S.F. No. 25,760

November 14, 2019

POHAKUWAAWAA MICROWAVE ANTENNA SITE

Hanalei and Waimea, Kauai, Hawaii

Being portions of the Government Land of Honopu and the Government  
(Crown) Land of Waimea.

Beginning at the east corner of this parcel of land, the coordinates of said  
point of beginning referred to Government Survey Triangulation Station "KALALAU" being  
12,630.34 feet South and 6701.02 feet West, thence running by azimuths measured clockwise  
from True South:-

1. 60° 37' 100.00 feet along Kokee Park, Governor's Executive Order  
1509;
2. 150° 37' 40.00 feet along Kokee Park, Governor's Executive Order  
1509;
3. 240° 37' 100.00 feet along Kokee Park, Governor's Executive Order  
1509;

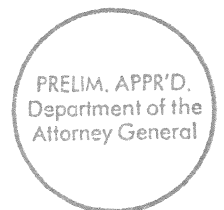

4. 330° 37' 40.00 feet along Kokee Park, Governor's Executive Order 1509 to the point of beginning and containing an AREA OF 4000 SQUARE FEET.

TOGETHER WITH, Perpetual, Non-Exclusive Access and Utility Easement (20 ft. wide) as shown on plan attached hereto and made a part hereof.

SURVEY DIVISION  
DEPARTMENT OF ACCOUNTING AND GENERAL SERVICES  
STATE OF HAWAII

By: *Meyer Cummins*  
Meyer A. Cummins  
Land Surveyor rk

Compiled from CSF 21,655  
and other Govt. Survey Records.

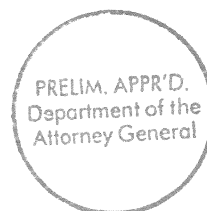

PRELIM. APPR'D.  
Department of the  
Attorney General

True North  
Scale: 1 in. = 200 ft.

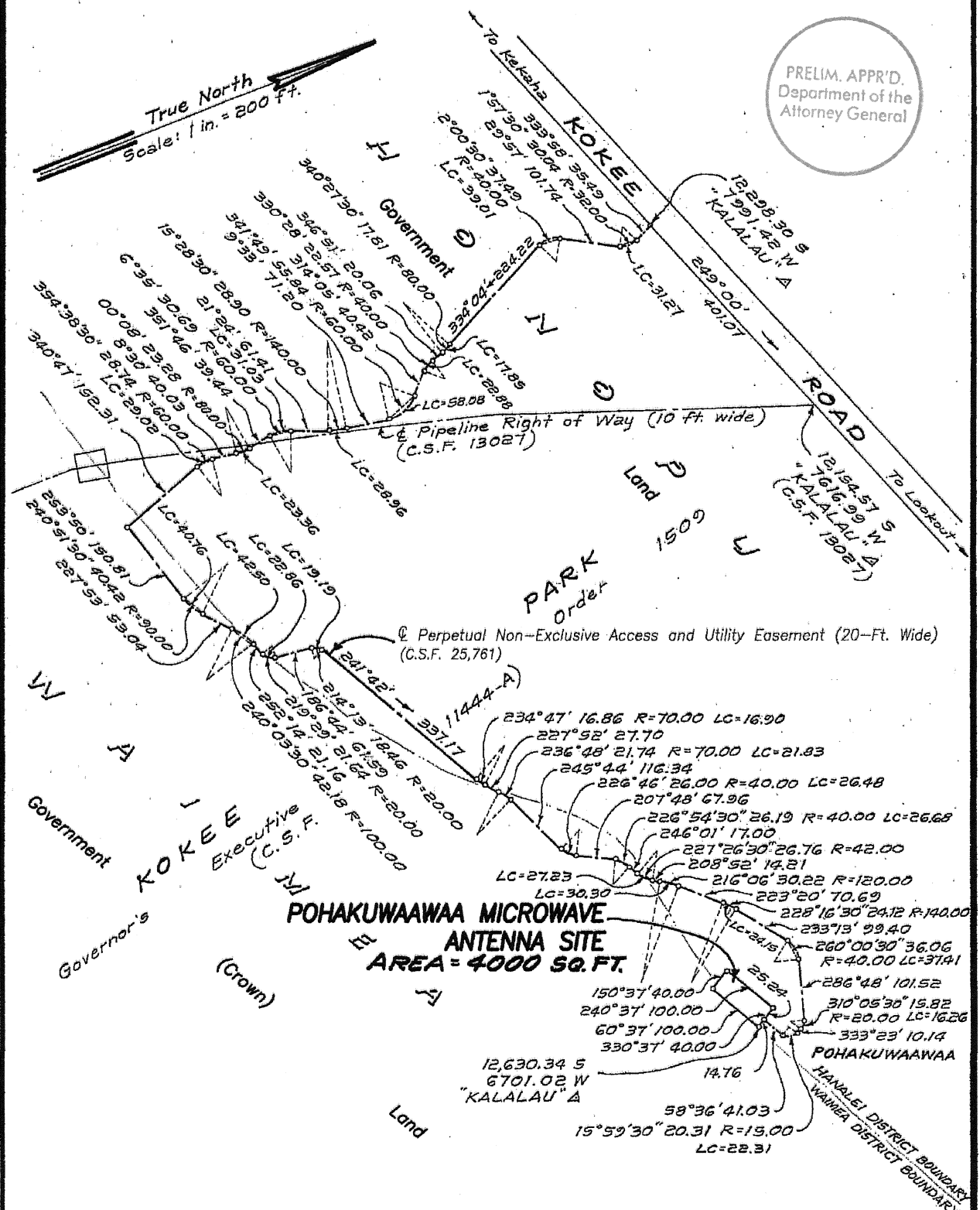

REDUCED NOT TO SCALE

### POHAKUWAAWAA MICROWAVE ANTENNA SITE

Hanalei and Waimea, Kauai, Hawaii

Job K-007(19)  
C. BK.

Scale: 1 inch = 200 feet

## EXHIBIT "B"

TMK 5-9-01: 23  
C.S.F. NO. 25,760

SURVEY DIVISION  
DEPARTMENT OF ACCOUNTING AND GENERAL SERVICES  
**STATE OF HAWAII**

MAC November 14, 2019



STATE OF HAWAI'I  
SURVEY DIVISION  
DEPARTMENT OF ACCOUNTING AND GENERAL SERVICES  
HONOLULU

C.S.F. No. 25,762

November 14, 2019

KUKUI MICROWAVE ANTENNA SITE

Waimea, Kauai, Hawaii

Being a portion of the Government (Crown) Land of Waimea.

Beginning at the north corner of this parcel of land and on the west side of Kokee Road, the true azimuth and distance to Government Survey Reference Station "KUKUI" being:  $318^{\circ} 26' 56''$  1729.04 feet and the coordinates of said point of beginning referred to Government Survey Triangulation Station "PUU KA PELE" being 9738.96 feet South and 1653.62 feet East, thence running by azimuths measured clockwise from True South:-

1.  $6^{\circ} 30'$  17.67 feet along the westerly side of Kokee Road;
2. Thence along the westerly side of Kokee Road on a curve to the left with a radius of 120.00 feet, the chord azimuth and distance being:  
 $333^{\circ} 15'$  131.59 feet;
3.  $300^{\circ} 00'$  50.00 feet along the westerly side of Kokee Road;
4. Thence along the westerly side of Kokee Road on a curve to the right with a radius of 225.00 feet, the chord azimuth and distance being:  
 $318^{\circ} 07'$  139.93 feet;
5.  $66^{\circ} 13' 47''$  59.72 feet along Waimea Canyon Park, Governor's Executive Order 1510;

PRELIM. APPR'D.  
Department of the  
Attorney General



- 6. 93° 32' 30" 346.41 feet along Waimea Canyon Park, Governor's Executive Order 1510;
- 7. 215° 16' 54" 329.24 feet along Waimea Canyon Park, Governor's Executive Order 1510;
- 8. 276° 30' 16.39 feet along Waimea Canyon Park, Governor's Executive Order 1510 to the point of beginning and containing an AREA OF 1.251 ACRES.

SURVEY DIVISION  
DEPARTMENT OF ACCOUNTING AND GENERAL SERVICES  
STATE OF HAWAII

By: *Meyer Cummins*  
Meyer A. Cummins  
Land Surveyor rk

Compiled from CSF 21,654  
and other Govt. Survey Records.

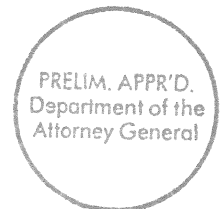

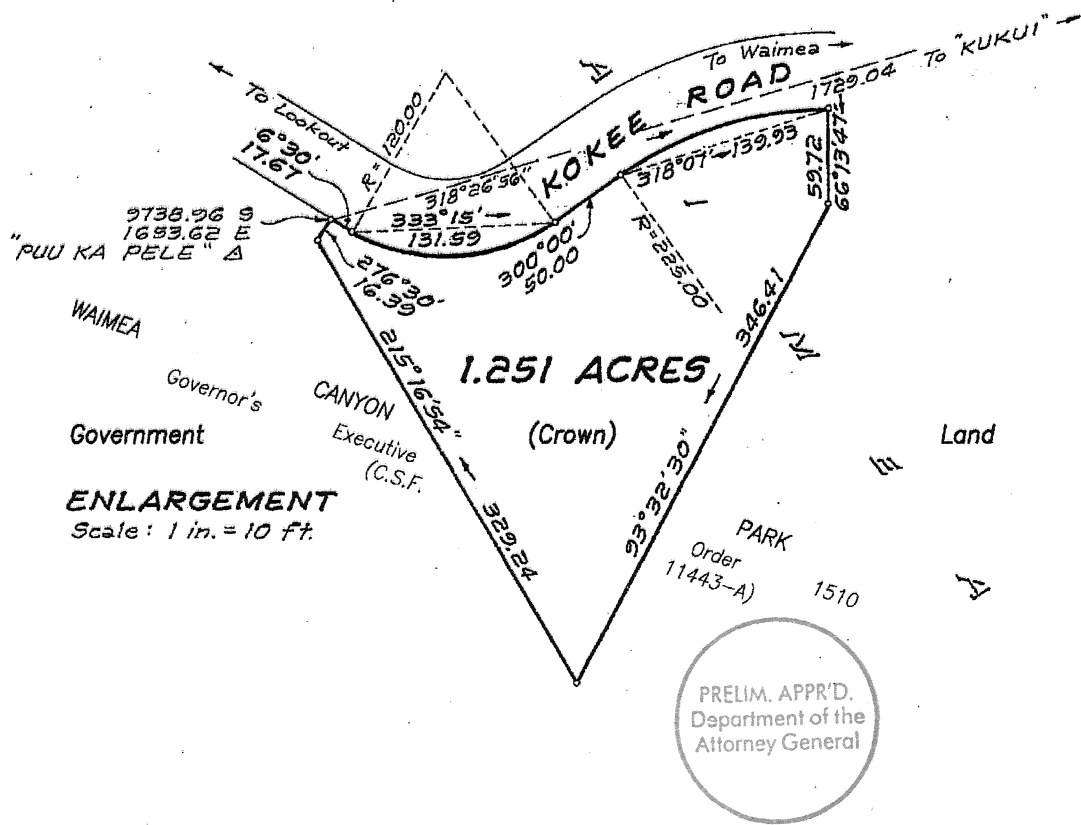
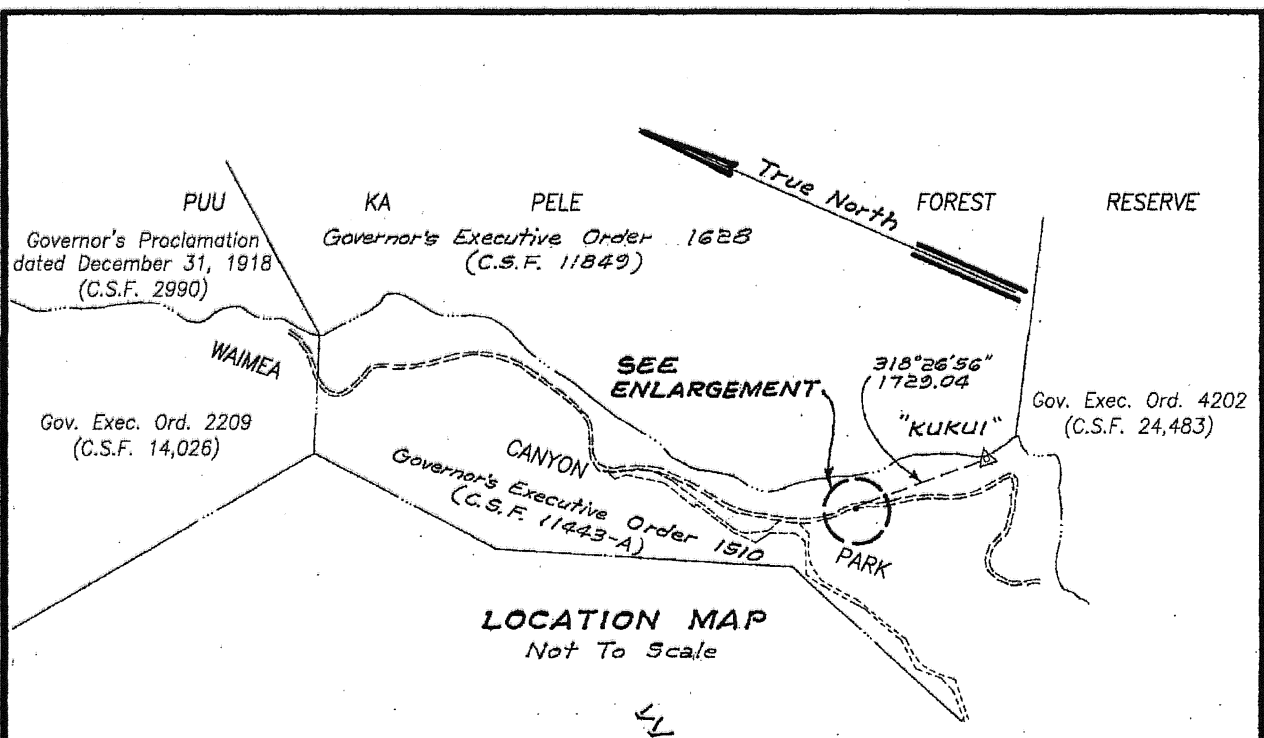

REDUCED NOT TO SCALE

# KUKUI MICROWAVE ANTENNA SITE

Waimea, Kauai, Hawaii

**EXHIBIT "D"**

Job K-007(19)  
C. BK.

Scale: 1 inch = 10 feet

TMK 1-2-01: 09

SURVEY DIVISION  
DEPARTMENT OF ACCOUNTING AND GENERAL SERVICES  
**STATE OF HAWAII**

C.S.F. NO. 25,762

MAC November 14, 2019