

FOR POTABLE WATER WELL PURPOSES, to be under the control and management of the County of Kauai, Department of Water, being that parcel of land and improvements situate at Kapaa, Kawaihau, Kauai, Hawaii, identified as "Potable Water Well Site," containing an area of 1.364 acres, together with Easements 1 and 2, Easement 1 for Perpetual Non-Exclusive Easement for Access and Utility Purposes, and Easement 2 for Perpetual Non-Exclusive Easement for Utility Purposes, and subject, however, to a portion of a Perpetual Non-Exclusive for Utility Purposes covered by Grant of Easement from the State of Hawaii to Citizens Utilities Company and Hawaiian Telephone Company dated December 5, 1983 and recorded in Liber 17737, Page 171 (Land Office Deed S-27404, all more particularly described in Exhibit "A" and delineated on Exhibit "B," both of which are attached hereto and made parts hereof, said exhibits being respectively, a survey description and survey map prepared by the Survey Division, Department of Accounting and General Services, State of Hawaii, both being designated C.S.F. No. 23,918 and dated November 24, 2004.

SUBJECT, HOWEVER, to the condition that upon cancellation of this executive order or in the event of non-use or abandonment of the premises or any portion thereof for a continuous period of one (1) year, or for any reason whatsoever, the County of Kauai, Department of Water shall, within a reasonable time, restore the premises to a condition satisfactory and acceptable to the Department of Land and Natural Resources, State of Hawaii.

SUBJECT, FURTHER, to disapproval by the Legislature by two-thirds vote of either the Senate or the House of Representatives or by majority vote of both, in any regular or special session next following the date of this Executive Order.

This executive order does not authorize the recipient of the set aside to sell or exchange or otherwise relinquish the State of Hawaii's title to the subject public land.

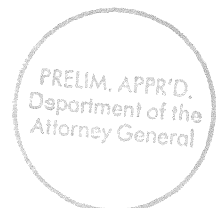

IN WITNESS WHEREOF, I have hereunto set my hand and caused the Great Seal of the State of Hawaii to be affixed. Done at the Capitol at Honolulu this 12th day of February, 2020.



DAVID Y. IGE
Governor of the State of Hawaii

APPROVED AS TO FORM:

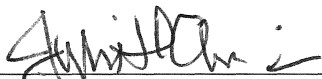

JULIE H. CHINA
Deputy Attorney General

Dated: January 27, 2020

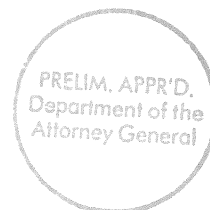

STATE OF HAWAII

Office of the Lieutenant Governor

THIS IS TO CERTIFY That the within is a true copy of Executive Order No. 4622 setting aside land and improvements for public purposes, the original of which is on file in this office.

IN TESTIMONY WHEREOF, the Lieutenant Governor of the State of Hawaii, has hereunto subscribed his name and caused the Great Seal of the State to be affixed.

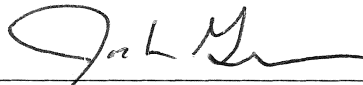

JOSH GREEN

Lieutenant Governor of the State of Hawaii

DONE in Honolulu, this 13th day of February, A.D. 2020

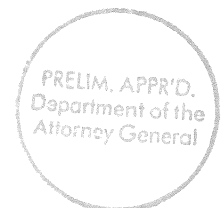



STATE OF HAWAII

SURVEY DIVISION

DEPT. OF ACCOUNTING AND GENERAL SERVICES
HONOLULU

C.S.F. No. 23,918

November 24, 2004

POTABLE WATER WELL SITE

Kapaa, Kawaihau, Kauai, Hawaii

Being a portion of the Government (Crown) Land of Kapaa.

Beginning at the northwest corner of this parcel of land and on the south side of Moikeha Canal, the coordinates of said point of beginning referred to Government Survey Triangulation Station "NONOU" being 7000.93 feet North and 11,066.43 feet East, thence running by azimuths measured clockwise from True South:-

- 1. 250° 44' 352.00 feet along the south side of Moikeha Canal;
- 2. 348° 52' 166.00 feet along Kapaa Rice and Kula Lots, Pasture Lease;
- 3. 53° 24' 30" 214.90 feet along Kapaa Rice and Kula Lots, Pasture Lease;
- 4. 125° 39' 81.92 feet along Kapaa Rice and Kula Lots, Pasture Lease;
- 5. 126° 24' 135.25 feet along Kapaa Rice and Kula Lots, Pasture Lease;
- 6. 160° 44' 49.60 feet along Kapaa Rice and Kula Lots, Pasture Lease to the point of beginning and containing an AREA OF 1.364 ACRES.

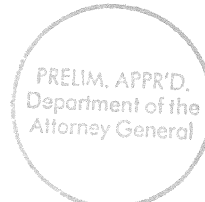

Together with Easements 1 and 2 over and across Kapaa Rice and Kula Lots, Pasture Lease as shown on plan attached hereto and made a part hereof and more particularly described as follows:

Being portions of the Government (Crown) Land of Kapaa.

Being also portions of Kapaa Rice and Kula Lots, Pasture Lease.

EASEMENT 1: Perpetual Non-Exclusive Easement for Access and Utility Purposes.

Beginning at the west corner of this easement and at the east corner of Alenae Street, the coordinates of said point of beginning referred to Government Survey Triangulation Station "NONOU" being 6669.74 feet North and 10,715.46 feet East, thence running by azimuths measured clockwise from True South:-

- 1. 233° 24' 30" 467.30 feet along the remainder of Kapaa Rice and Kula Lots, Pasture Lease;
- 2. 306° 24' 41.83 feet along Potable Water Well Site;
- 3. 53° 24' 30" 459.54 feet along the remainder of Kapaa Rice and Kula Lots, Pasture Lease;
- 4. 8° 24' 30" 28.28 feet along the remainder of Kapaa Rice and Kula Lots, Pasture Lease;
- 5. 143° 24' 30" 60.00 feet along the remainder of Kapaa Rice and Kula Lots, Pasture Lease and the northeast end of Alenae Street to the point of beginning and containing an AREA OF 19,137 SQUARE FEET.

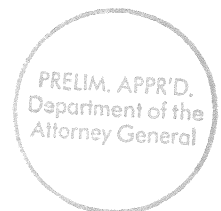

EASEMENT 2: Perpetual Non-Exclusive Easement for Utility Purposes.

Beginning at the north corner of this easement and at the east corner of Alenae Street, the coordinates of said point of beginning referred to Government Survey Triangulation Station "NONOU" being 6637.63 feet North and 10,739.31 feet East, thence running by azimuths measured clockwise from True South:-

1. 323° 24' 30" 20.00 feet along the remainder of Kapaa Rice and Kula Lots, Pasture Lease;
2. 53° 24' 30" 20.00 feet along the remainder of Kapaa Rice and Kula Lots, Pasture Lease;
3. 323° 24' 30" 477.72 feet along the remainder of Kapaa Rice and Kula Lots, Pasture Lease;
4. 47° 19' 10.06 feet along the remainder of Kapaa Rice and Kula Lots, Pasture Lease;
5. 143° 24' 30" 498.79 feet along Grant S-14,315 to Hawaii Housing Authority;
6. 233° 24' 30" 30.00 feet along the southeast side of Alenae Street to the point of beginning and containing an AREA OF 5383 SQUARE FEET.

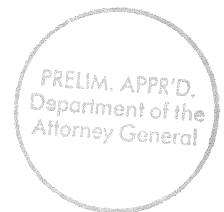

The above-described Potable Water Well Site is subject, however, to a portion of a Perpetual Non-Exclusive Easement for Utility Purposes covered by Grant of Easement from the State of Hawaii to Citizens Utilities Company and Hawaiian Telephone Company dated December 5, 1983 and recorded in Liber 17737, Page 171 (Land Office Deed S-27404) as shown on plan attached hereto and made a part hereof and more particularly described as follows:

Beginning at the south corner of this easement, being also the end of Course 3 of the above-described Potable Water and Well Site, thence running by azimuths measured clockwise from True South:-

- 1. 125° 39' 81.92 feet along Kapaa Rice and Kula Lots, Pasture Lease;
- 2. 126° 24' 135.25 feet along Kapaa Rice and Kula Lots, Pasture Lease;
- 3. 160° 44' 3.51 feet along Kapaa Rice and Kula Lots, Pasture Lease;
- 4. 305° 35' 221.33 feet;

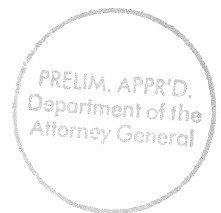

C.S.F. No. 23,918

November 24, 2004

5. 53° 24' 30"

4.25 feet along Kapaa Rice and Kula Lots, Pasture Lease to the point of beginning and containing an AREA OF 737 SQUARE FEET.

SURVEY DIVISION
DEPARTMENT OF ACCOUNTING AND GENERAL SERVICES
STATE OF HAWAII

By: Glenn J. Kodani
Glenn J. Kodani
Land Surveyor gm

Compiled from CSF 21360 and other Govt. Survey Records.

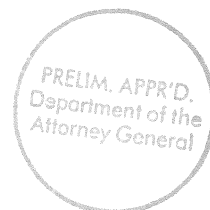
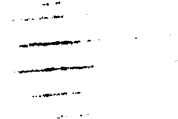
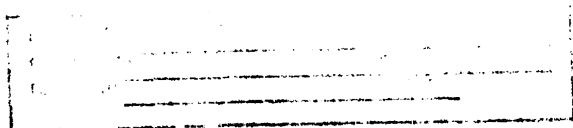

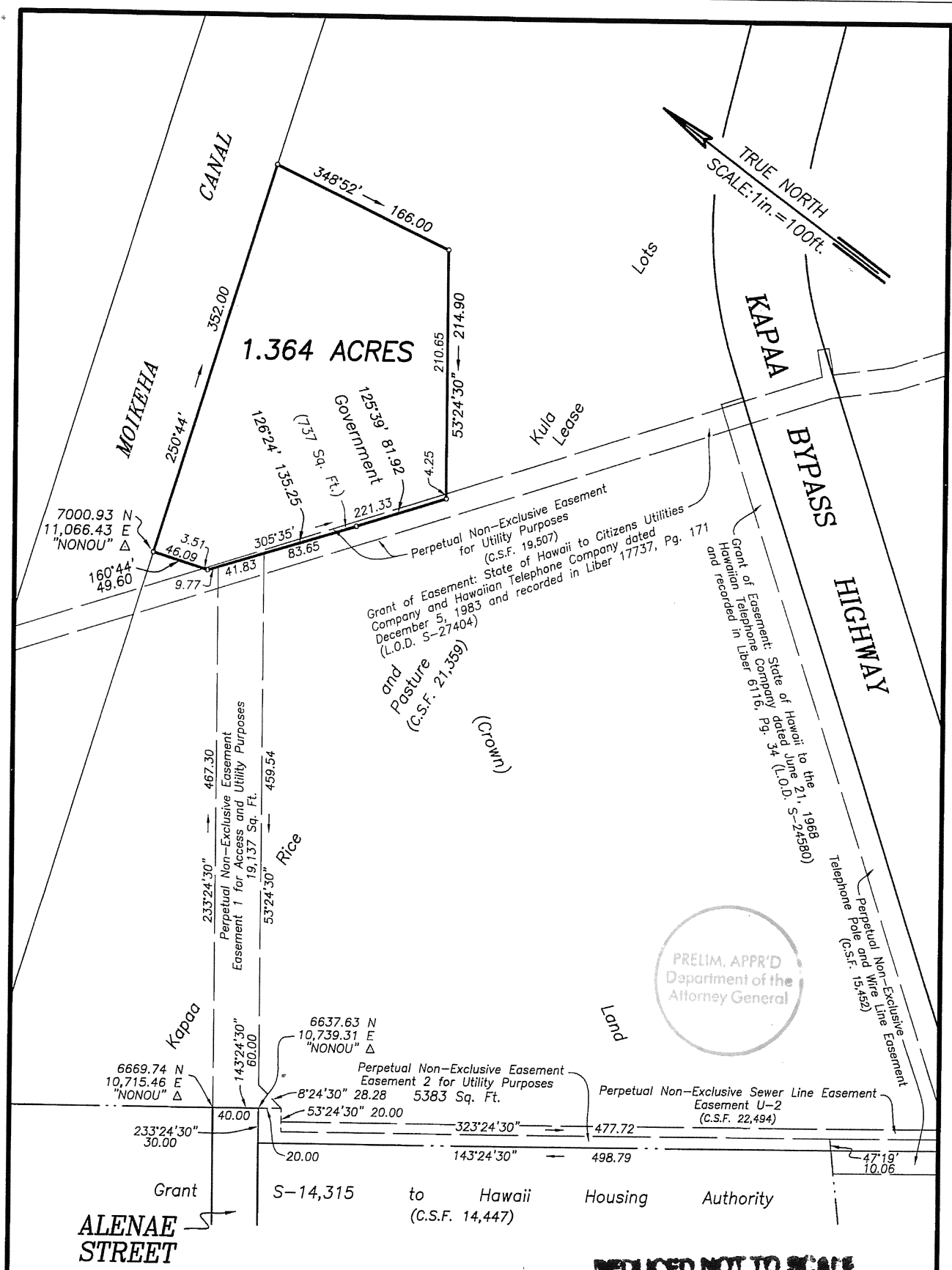

REDUCED NOT TO SCALE

POTABLE WATER WELL SITE

Kapaa, Kawaihau, Kauai, Hawaii

EXHIBIT "B"

JOB K-240(04)
C. BK.

Scale: 1 inch = 100 feet

TAX MAP 4-5-15

SURVEY DIVISION
DEPARTMENT OF ACCOUNTING AND GENERAL SERVICES
STATE OF HAWAII

C.S.F. NO. 23,918

JGL November 24, 2004