

Site," containing an area of 1.615 acres, SUBJECT, HOWEVER, to the following easements:

1. Perpetual Non-Exclusive Drainage Easement, Easements A-1 and A-2; and
2. Perpetual Non-Exclusive Guy Wire and Anchor Easement, Easement 3 covered by Grant of Easement: State of Hawaii to Hawaiian Electric Company, Inc. dated June 3, 1996 and recorded as Doc. No. 96-080657 thru 96-080658 (Land Office Deed S-28155), more particularly described in Exhibit "A" and delineated on Exhibit "B," both of which are attached hereto and made parts hereof, said exhibits being respectively, a survey description and survey map prepared by the Survey Division, Department of Accounting and General Services, State of Hawaii, both being designated C.S.F. No. 25,847 and dated February 26, 2021.

SUBJECT, HOWEVER, to any existing encumbrances and reservations, and the condition that upon cancellation of this executive order or in the event of non-use or abandonment of the premises or any portion thereof for a continuous period of one (1) year, or for any reason whatsoever, the State of Hawaii, Department of Land and Natural Resources, Division of Aquatic Resources shall, within a reasonable time, restore the premises to a condition satisfactory and acceptable to the Department of Land and Natural Resources, State of Hawaii.

SUBJECT, FURTHER, to disapproval by the Legislature by two-thirds vote of either the Senate or the House of Representatives or by majority vote of both, in any regular or special session next following the date of this Executive Order.

This executive order does not authorize the recipient of the set aside to sell or exchange or otherwise relinquish the State of Hawaii's title to the subject public land.

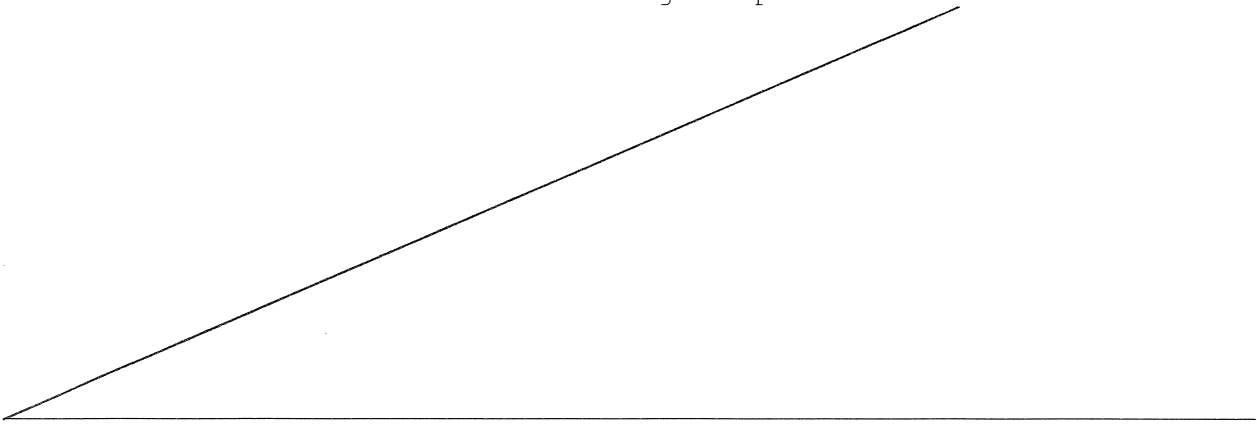

IN WITNESS WHEREOF, I have hereunto set my hand and caused the Great Seal of the State of Hawaii to be affixed. Done at the Capitol at Honolulu this 5th day of April, 2021.



DAVID Y. IGE
Governor of the State of Hawaii

APPROVED AS TO FORM:



LAUREN K. CHUN
Deputy Attorney General

Dated: 3/12/2021

STATE OF HAWAII

Office of the Lieutenant Governor

THIS IS TO CERTIFY That the within is a true copy of Executive Order No. 4652 setting aside land and improvements for public purposes, the original of which is on file in this office.

IN TESTIMONY WHEREOF, the Lieutenant Governor of the State of Hawaii, has hereunto subscribed his name and caused the Great Seal of the State to be affixed.

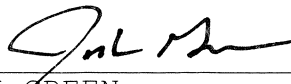

JOSH GREEN

Lieutenant Governor of the State of Hawaii

DONE in Honolulu, this 7th day of
April, A.D. 2021

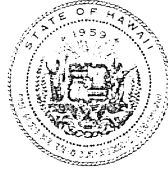

STATE OF HAWAI'I
LAND SURVEY DIVISION
DEPARTMENT OF ACCOUNTING AND GENERAL SERVICES
HONOLULU

C.S.F. No. 25,847

February 26, 2021

ADDITION TO
FISHERIES RESEARCH CENTER
AND RELATED PURPOSES SITE

Kaholaloea, Sand Island, Honolulu, Oahu, Hawaii

Being a portion of the former Kaholaloea Fishery conveyed to the State of Hawaii by the United States of America by Quitclaim Deed, Parcel 2 dated July 23, 1965 and recorded in Liber 5334, Page 226 (Land Office Deed S-24133).

Beginning at the northwest corner of this parcel of land, at the southwest corner of Fisheries Research Center and Related Purposes Site, Governor's Executive Order 4618 and on the northeast side of Sand Island Parkway, the coordinates of said point of beginning referred to Government Survey Triangulation Station "U.S.E. NORTH BASE" being 28.59 feet South and 68.67 feet East, thence running by azimuths measured clockwise from True South:-

1. 271° 00' 29.83 feet along Fisheries Research Center and Related Purposes Site, Governor's Executive Order 4618;
2. Thence along Fisheries Research Center and Related Purposes Site, Governor's Executive Order 4618 on a curve to the left with a radius of 48.00 feet, the chord azimuth and distance being: 256° 00' 24.85 feet;

3. 241° 00' 265.56 feet along Fisheries Research Center and Related Purposes Site, Governor's Executive Order 4618;
4. 151° 00' 104.20 feet along Fisheries Research Center and Related Purposes Site, Governor's Executive Order 4618;
5. 241° 00' 27.22 feet along Fisheries Research Center and Related Purposes Site, Governor's Executive Order 4618;
6. 331° 05' 153.10 feet along Honolulu Harbor, Governor's Executive Order 4006;
7. 331° 14' 257.30 feet along Honolulu Harbor, Governor's Executive Order 4006;
8. 61° 00' 168.95 feet along Sand Island State Recreational Area, Governor's Executive Order 2704;
9. 151° 00' 190.19 feet along Sand Island State Recreational Area, Governor's Executive Order 2704;
10. 61° 00' 101.50 feet along Sand Island State Recreational Area, Governor's Executive Order 2704;
11. 151° 00' 67.58 feet along Sand Island State Recreational Area, Governor's Executive Order 2704;
12. 61° 06' 70.89 feet along Sand Island State Recreational Area, Governor's Executive Order 2704;
13. 151° 00' 69.65 feet along the northeast side of Sand Island Parkway to the point of beginning and containing an AREA OF 1.615 ACRES.

SUBJECT, HOWEVER, to the following easements as shown on plan attached hereto and made a part hereof:

1. Perpetual Non-Exclusive Drainage Easement, Easements A-1 and A-2.

2. Perpetual Non-Exclusive Guy Wire and Anchor Easement, Easement 3 covered by Grant of Easement: State of Hawaii to Hawaiian Electric Company, Inc. dated June 3, 1996 and recorded as Doc. No. 96-080657 thru 96-080658 (Land Office Deed S-28155).

SURVEY DIVISION
DEPARTMENT OF ACCOUNTING AND GENERAL SERVICES
STATE OF HAWAII

By: 
Gerald Z. Yonashiro
Land Surveyor rm

Compiled from CSF 21,710 and other
Gov't. Survey records.

United States of America to the State of Hawaii by Act of March 18, 1898, Public Law 25-80, 73 Stat. 4

Deed: (Part 2) B. P. Bishop, September 9, 1891, Trustees under the Will and of the Estate of Deceased to The Minister of Interior dated Liber 135, Pages 38-43 (L.O.D. 344)

R.P. 4483, L.C. Aw. 7712, Ap. 6 to Kekuanana for V. Kamamalu

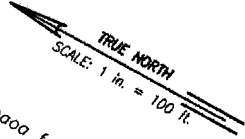

HONOLULU HARBOR
 Governor's Executive Order 4006
 (C.S.F. 23,525)

Perpetual Non-Exclusive Easement for Boating and Ocean Recreation Purposes and for Ingress and Egress to and from the small boat harbors in favor of the Division of Boating and Ocean Recreation of the Department of Land and Natural Resources, subject to the Harbor Master Notice 5-97 dated June 10, 1997, as may be amended in favor of Harbors Division of the Department of Transportation

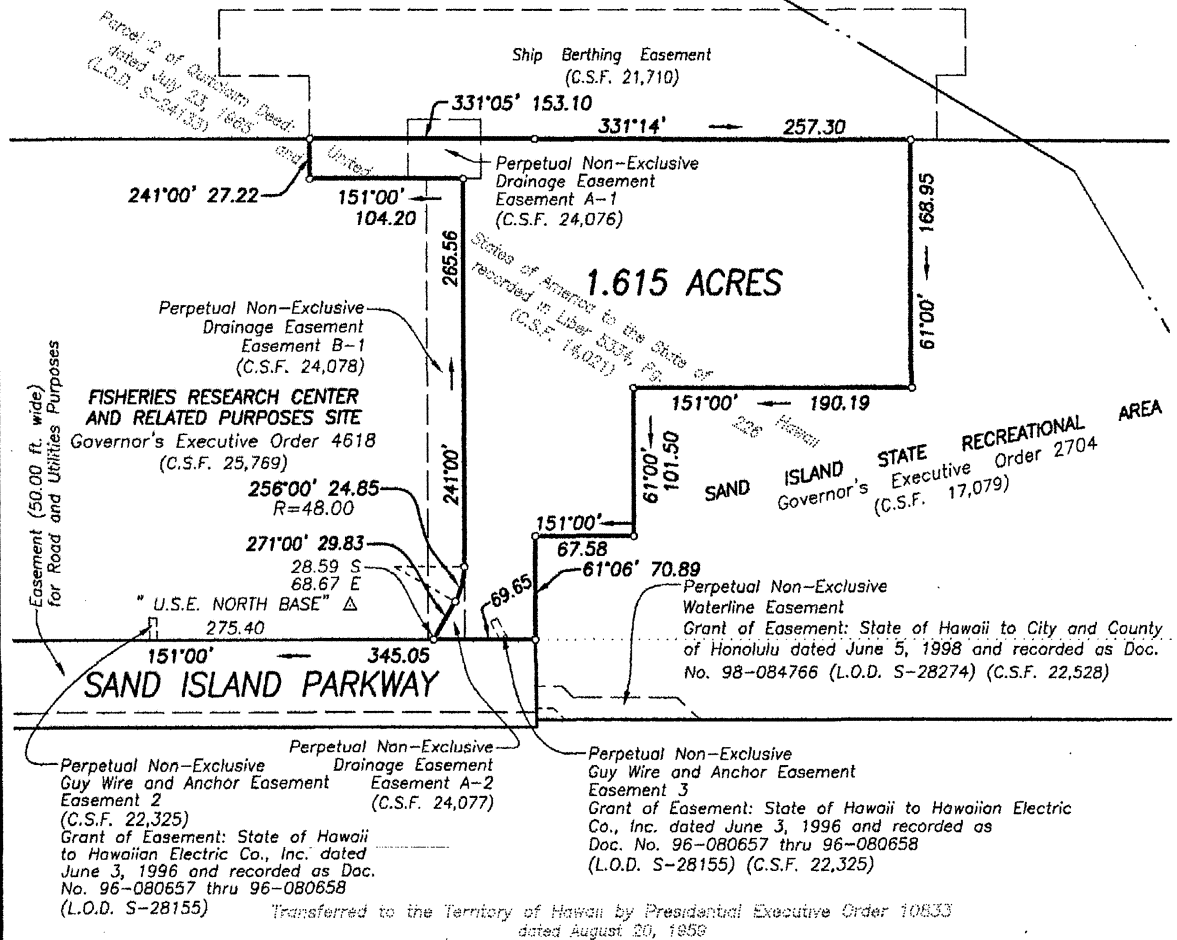

SAND ISLAND INDUSTRIAL PARK SUBDIVISION
 File Plan 2102

REDUCED NOT TO SCALE **EXHIBIT "B"**
ADDITION TO
FISHERIES RESEARCH CENTER
AND RELATED PURPOSES SITE
 Kaholaloa, Sand Island, Honolulu, Oahu, Hawaii

Job 0-011(21) Scale: 1 inch = 100 feet
 C. BK.